



PUTTERILLS

EST. 1992

3 The Heath, Breachwood Green SG4 8PJ
Guide price £250,000

This delightful cottage dates back to the turn of the century and benefits from an extension and modernising in recent times.

The windows have been replaced with upvc double glazing and there is gas central heating, keeping the cottage warm throughout the winter. The re-fitted kitchen is a modern with an integrated oven, hob, extractor and dishwasher. Bedroom one offers superb countryside views over fields. Externally, there is a courtyard garden with ample space for alfresco dining. We have been advised that there is an allotment which can be rented for £15 a year should more outside space be required.

Breachwood Green is a wonderful semi-rural village located within Hertfordshire's metropolitan Green Belt. The village provides a lovely public house and a well-regarded JMI school, and the larger towns of Harpenden, Luton and Hitchin are all within a short drive with their larger shopping facilities and schools. The M1 is just a ten minute drive away and access to London on train is available from Luton Parkway (fast train 23 minutes) and Harpenden.

GROUND FLOOR

SITTING ROOM 11'8 X 11'8

Feature fireplace

KITCHEN/DINER 12'7 X 5'5

FIRST FLOOR

BEDROOM ONE 11'7 X 10'2

Views over countryside

BEDROOM TWO 9' X 7'4

BATHROOM

EXTERNAL

GARDEN

TENURE

Freehold

EPC

EER: C

FLOORPLAN DISCLAIMER

Floorplans are provided for guidance only. They are not to scale and must not form any part of a legal contract or be reproduced without the written consent of a partner of Putterills.

VIEWING INFORMATION

By appointment only through Putterills of Hertfordshire, through whom all negotiations should be conducted.

SANDS FINANCIAL

We offer impartial, whole of market mortgage advice and insurance products from a selected panel of providers. So whether you are a first-time buyer, buying to let or moving

house, we will help you find the best deal. Please contact us on 01462 632222.

MONEY LAUNDERING

Prior to a sale being agreed, prospective purchasers will be required to produce identification documents. Your co-operation with this, in order to comply with Money Laundering regulations, will be appreciated and assist with the smooth progression of the sale.





Ground Floor

Approx. 26.6 sq. metres (286.3 sq. feet)

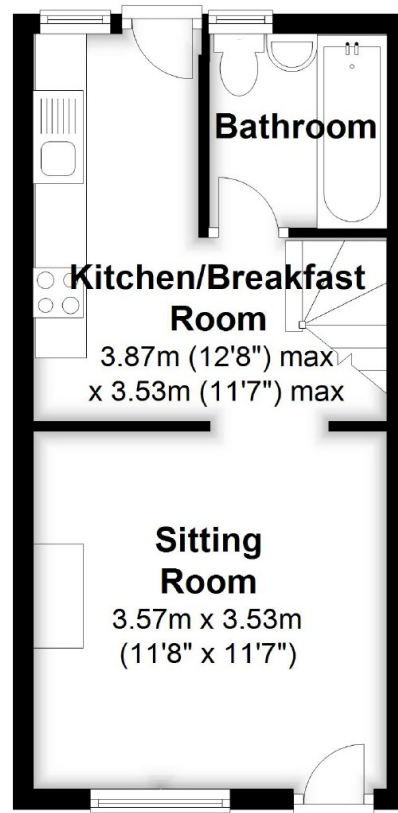

First Floor

Approx. 19.4 sq. metres (208.9 sq. feet)

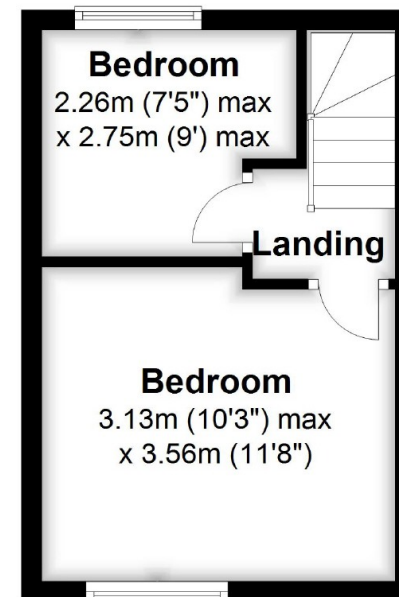

Total area: approx. 46.0 sq. metres (495.2 sq. feet)



PUTTERILLS

EST. 1992

putterills.co.uk | 01462 632222 | hitchin@putterills.co.uk

You may download, store and use the material for your own personal use and research. You may not republish, retransmit, redistribute or otherwise make the material available to any party or make the same available on any website, online service or bulletin board of your own or of any other party or make the same available in hard copy or in any other media without the website owner's express prior written consent. The website owner's copyright must remain on all reproductions of material taken from this website.