



Ruxley Lane, West Ewell, KT19 9HA



# £235,000

Two Double Bedrooms  
Lounge / Dining Room  
Modern Kitchen  
Refitted Bathroom  
Well Presented Throughout  
Extended Lease  
Walk to Schools & Shops

This well presented two double bedroom apartment is conveniently located within easy walking distance of local schools, shops and transport links.

The property offers a modern kitchen with a range of white units and granite effect work surfaces, and a stylish bathroom which has been refitted.



There are two double bedrooms including the 15ft Master bedroom, and a spacious lounge / dining room.

Early viewing highly recommended by sole agents.

Ewell Village offers a variety of shops, restaurants, cafés and pubs. Bourne Hall hosts a public library, subterranean theatre, gymnasium, café, and local museum. It regularly holds gatherings such as fayres.

In the heart of the village lies the Hogsmill river leading up to the nature reserve. There are a range of popular local schools and of course both Ewell East and West stations with their connections to London.

Leasehold



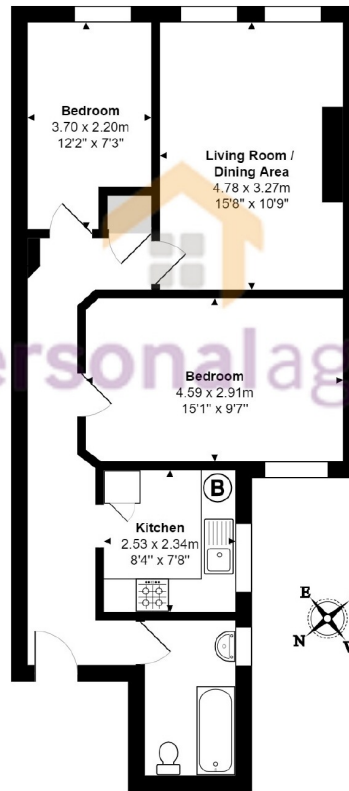

#### First Floor Flat

Ruxley Lane, West Ewell

Total Area: 60.9 m<sup>2</sup> ... 656 ft<sup>2</sup>

FOR ILLUSTRATIVE PURPOSES ONLY.

Whilst every attempt has been made to ensure the accuracy of the floor plan shown, all measurements, positioning, fixtures, features, fittings and any other data shown are an approximate interpretation for illustrative purposes only and are not to scale.

No responsibility is taken for any error, omission, miss-statement or use of data shown.

The above statement applies to both 'Still Moving London LTD' and the Company or individual displaying this floor plan.

Unauthorised reproduction prohibited.

© Still Moving London LTD (www.stillmoving.london)



#### Epsom Office

2 West Street  
Epsom, Surrey KT18 7RG

T: 01372 745 850

#### Ewell Office

220 Chessington Road  
West Ewell, Surrey KT19 9XA

T: 020 8394 1234

#### Stoneleigh Office

62 Stoneleigh Broadway  
Stoneleigh, Surrey KT17 2HS

T: 020 8393 9411

#### Banstead Office

141 High Street Banstead,  
Surrey SM7 2NS

T: 01737 333699



sales@thepersonalagent.co.uk | thepersonalagent.co.uk

**Please Note:** Whilst every attempt has been made to ensure the accuracy of the floorplans contained here, measurements of doors, windows and room areas are approximate and no responsibility is taken for any error, omission or mis-statement. These plans are for representation purposes only and should be used as such by and prospective purchaser. The services, systems and appliances listed in the specification have not been tested by The Personal Agent and no guarantee as to their operating ability or their efficiency can be given. All images and text used to advertise our properties are for the sole use of The Personal Agent Ltd.

