

BROMLEY

ALDERLEY EDGE



Andrew J Nowell
& Company

www.andrewjnowell.co.uk

BROMLEY, 1 CHAPEL ROAD, ALDERLEY EDGE, SK9 7DX

A beautifully maintained 1940's extended semi-detached property located in the heart of the village with charming secluded rear garden.

- Entrance hall
- Lounge
- Dining Kitchen
- Orangery
- 2 Bathrooms
- 3 Bedrooms
- Good sized well stocked secluded gardens
- Flagged entrance drive providing parking facilities



Bromley occupies a highly desirable and sought after secluded location in the heart of the village. Alderley Edge village offers a good range of shopping including the Waitrose supermarket, stylish boutiques and fine restaurants. The area is renowned for its excellent schooling and The Edge is a well-known beauty spot of historical importance with excellent walks. The motorway network system is within easy access, as is Manchester International Airport, local and commuter rail links to Manchester and London.





Bromley has been carefully and tastefully extended and remodelled by the current owners offering well balanced spacious accommodation with UPVC double glazing and a comprehensive gas heating system.

On the ground floor the lounge has period style fireplace and curved bay window, dining kitchen with Shaker style units leading to side orangery. The inner hall has a ground floor bathroom.

To the first floor there are three bedrooms and second bathroom.

Externally the property is approached via a flagged driveway bordered by stone sets providing good parking facilities. The secluded rear garden is laid out to lawn with flagged patio, walling, trees and shrubs. There is a shed/summerhouse with a covered area and a further timber summerhouse.

DIRECTIONS – SK9 7DX

From our Alderley Edge office proceed out of the village on the main London Road (A34) in a southerly direction. After passing Gusto turn left into Chapel Road. Bromley, 1 Chapel Road will be found a short distance on the left hand side.



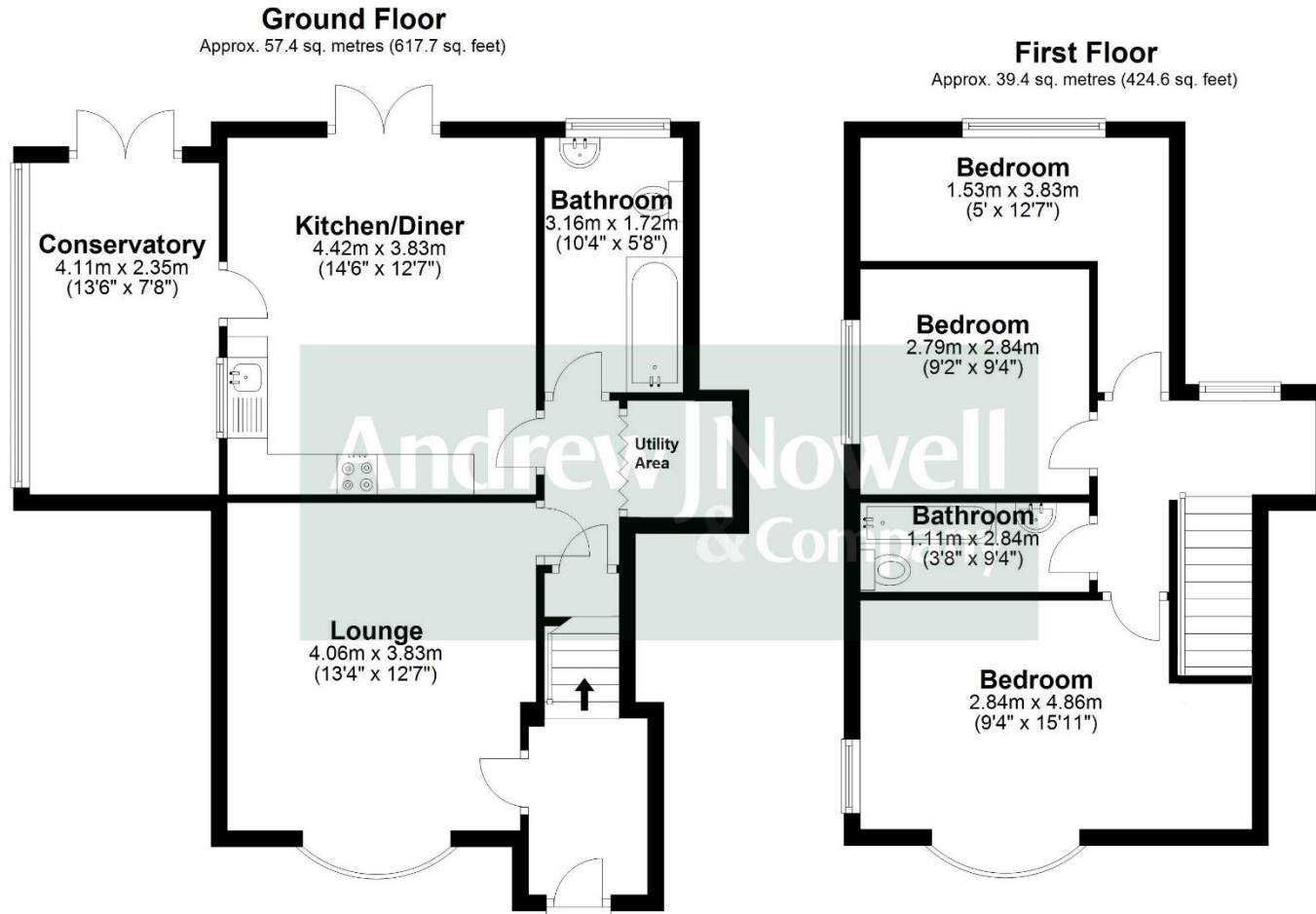

1 Chapel Road, Alderley Rdge

N.B. Andrew J. Nowell & Company for themselves and for the vendors or lessors of this property whose agents they are give notice that: 1. The particulars are set out as a general outline only for the guidance of intending purchasers or lessees and do not constitute nor constitute part of an offer or contract. 2. All descriptions, dimensions, references to condition or necessary permissions for use and occupation and other details are given without responsibility and any intending purchasers or tenants should not rely on them as statements or representations of fact but must satisfy themselves by inspection or otherwise as to the correctness of each of them. 3. No person in the employment of Andrew J. Nowell & Company has any authority to make or give any representation or warranty whatever in relation to this property.

N006 Ravensworth 01670 713330

8 London Road, Alderley Edge, Cheshire
SK9 7JS

Email: mail@andrewjnowell.co.uk

T 01625 585905

www.andrewjnowell.co.uk

**Andrew J Nowell
& Company**