

JULIAN
WADDEN





Plot 5 Mauldeth Green Burnage Guide price £299,950



Square Footage:
Council Tax Band:
Tenure: Leasehold
Service Charge: Around £250pa
Sat Nav Directions: M19 1DZ

The Irwell - A 3 bedroom Semi-Detached property offering 1080sqft of stunning accommodation over 3 floors.

Entrance hall with a separate WC, stunning open plan living area comprises of the dining and kitchen area leading into the Lounge area. On the first floor, there are two double bedrooms and a family bathroom, the second floor hosts the master bedroom and en-suite and a study to the front of the property.

*NB - Photographs illustrate the show house only.



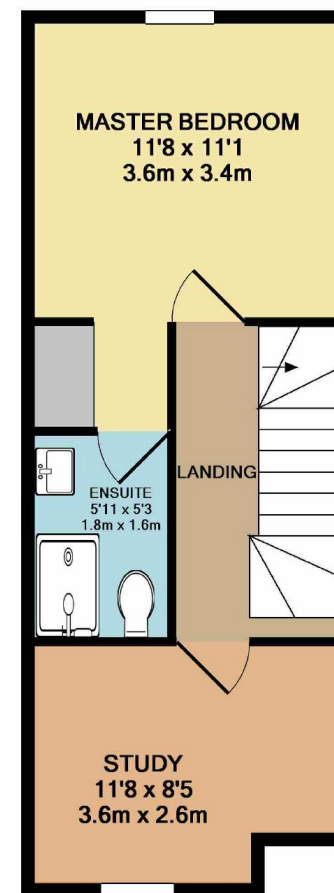
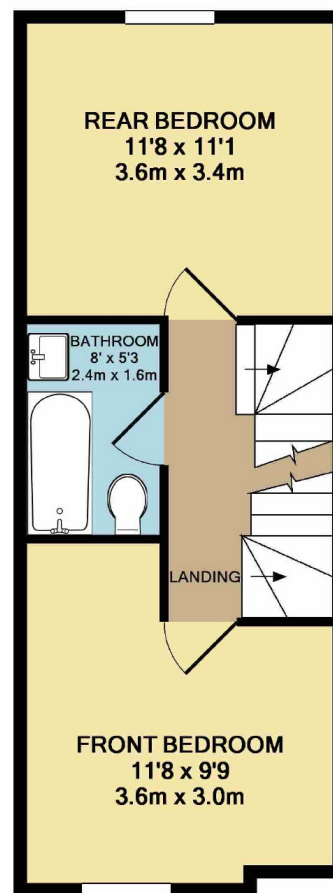
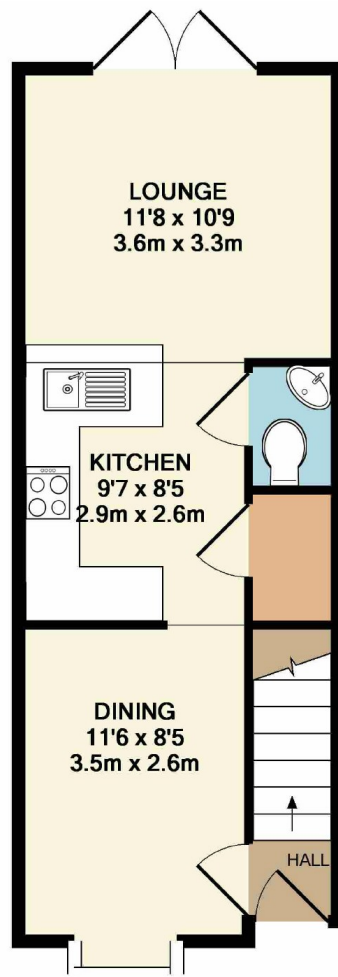

TOTAL APPROX. FLOOR AREA 1107 SQ.FT. (102.9 SQ.M.)
Made with Metropix ©2018

Heaton Moor Branch
14 Moorside Road, Heaton Moor, Stockport, Cheshire, SK4 4DT | 0161 432 1115
theheatons@julianwadden.co.uk | www.julianwadden.co.uk

Please note these particulars have been prepared as a general guidance only. A survey has not been carried out, nor services, appliances or fittings tested. Room sizes should not be relied upon for furnishing purposes and are approximate. Floor plans are for guidance and illustration only and may not be to scale. Neither Julian Wadden & Co, nor the vendor, accept any responsibility in respect of these particulars and if there are any matters likely to affect your decision to buy please consult your legal representative.

**JULIAN
WADDEN**

FOR FACTS STATS AND ALL THINGS HEATONS VISIT
WWW.THEHEATONSPROPERTYBLOG.COM

rightmove

The Property
Ombudsman