



## Building Plots Adjacent to Fairview, Gravels Bank, Minsterley, Shrewsbury, SY5 0HG

Roger Parry and Partners are delighted to offer for sale these two quality building plots located in the hamlet of the Gravels situated in the picturesque South Shropshire Hills. The plots are available either individually or as a pair and possess outline planning permission for detached dwellings with detached garages and for formation of a new vehicular access and alterations to the existing access. As per planning application number 16/04879/OUT. Brief information with regards to the plots are included within these details and further information can be obtained from Shropshire County Council Planning Portal website (using the planning number above).

**Plot 1 extends to approximately 1040m<sup>2</sup> or thereabouts** slightly over ¼ of an acre and will have its own private driveway. **Plot 2 is slightly larger at approximately 1150m<sup>2</sup> or thereabouts** again over ¼ of an acre. Both plots enjoy lovely elevated open outlooks over surrounding hills and countryside.

A small paddock is situated to the rear of the plots extending to approximately ½ an acre or thereabouts and is available by separate negotiation.

**VIEWING BY APPOINTMENT ONLY- PLEASE CONTACT AGENTS**

**Offers in the region of £119,950 per plot**

**To view this property call 01743 343 343**

44 High Street, Shrewsbury SY1 1ST

Phone 01743 343343 Fax 01743 248531

Associated Offices at

Roger Parry  
& Partners

Minsterley  
01743 791336  
mail@rogerparry.net

Oswestry  
01691 655334  
oswestry@rogerparry.net

Welshpool  
01938 554499  
welshpool@rogerparry.net



PLEASE NOTE ALL PLANS INCLUDED WITHIN THESE DETAILS ARE NOT TO SCALE AND ARE FOR IDENTIFICATION PURPOSES ONLY

## Site Plan

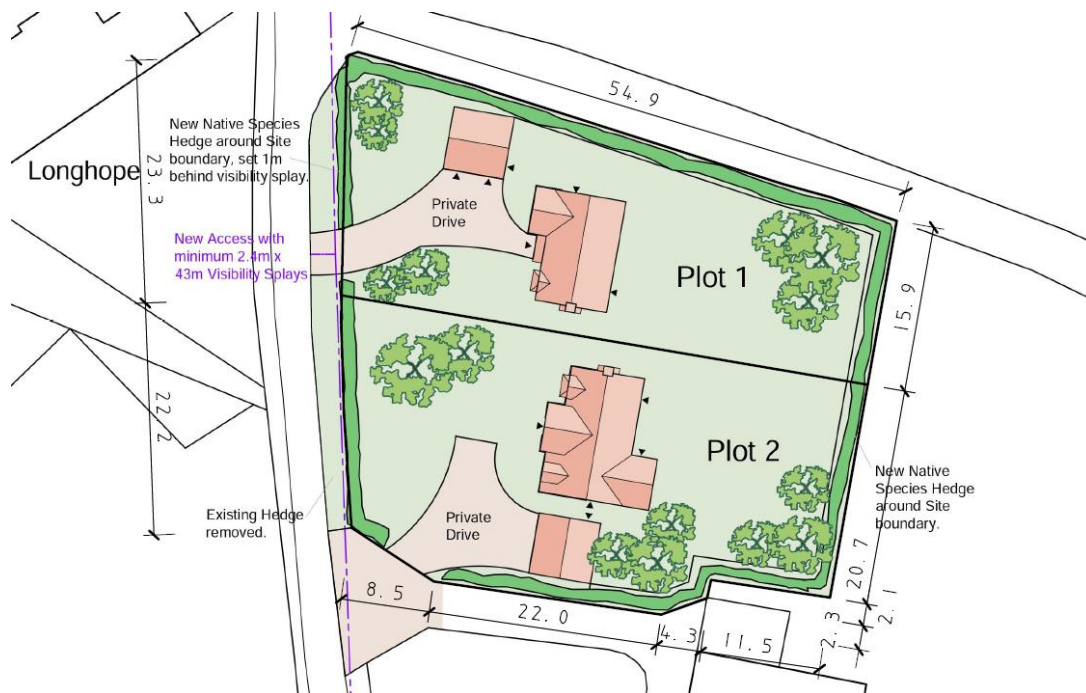

## Location Plan

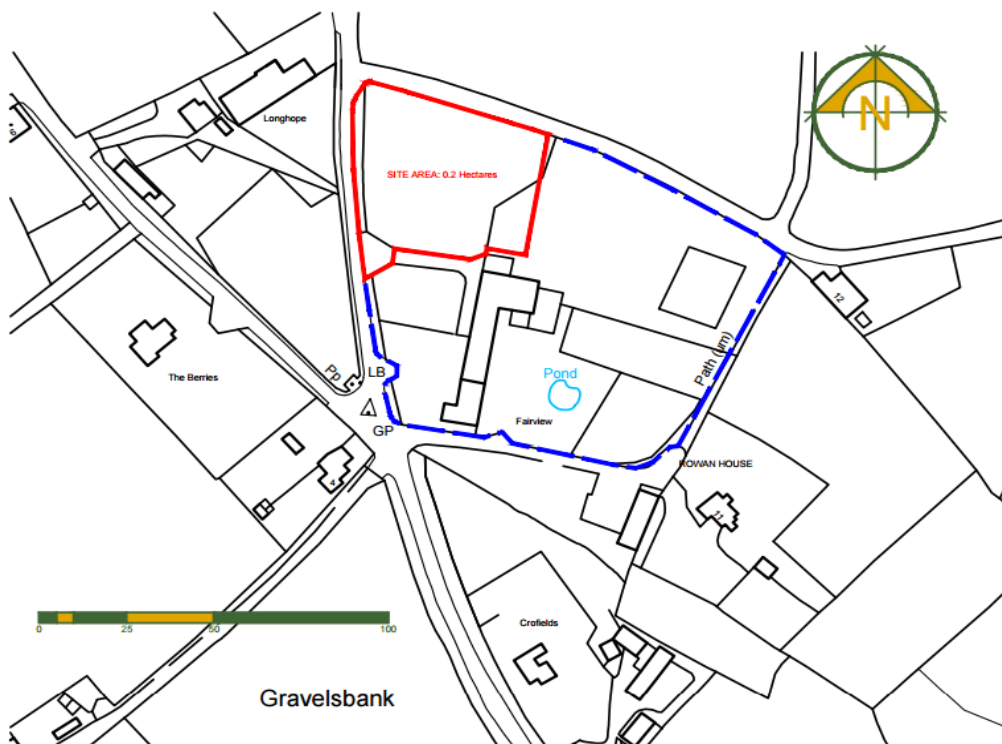

**DIRECTIONS:** From Shrewsbury take the A488 Bishops Castle/Minsterley road. Continue on through the villages of Hanwood, Pontesbury and Minsterley. Continue up Hope Valley and beyond until you come to the turning for Gravels Bank on the right hand side. Turn right and continue on up the bank into the hamlet. As you come into the centre of the Hamlet fork right towards Bentlawnt. The plots are situated shortly after on the right hand side as indicated by the For Sale sign.

Whilst Parry Lowarch endeavour to provide prospective clients with accurate yet informative sales particulars, descriptions of many features of any given property are of a subjective and personal nature. We advise prospective purchasers to contact us to discuss the property's suitability prior to viewing, particularly if travelling a distance to view.

Parry Lowarch for themselves, and the vendor of this property whose agents they are, give notice that these particulars do not constitute in any part an offer or contract. All statements herein are made without responsibility on the part of Parry Lowarch, or the vendor, and must not be relied upon as a statement or representative of fact. Any intending purchaser must satisfy himself by inspection, or otherwise, as to the correctness of each of the statements contained in these particulars.