



**THORNLEY
GROVES**

1 Century Buildings St Marys Parsonage City Centre M3 2DD



- Sought After Development
- Popular Location
- Idyllic Garden Views
- Living Room
- Large Original Windows
- Integrated Kitchen
- Two Double Bedroom
- Fitted Wardrobes
- High Specification
- Subject To Contract

£300,000

25 Whitworth St West, Manchester, M1 5ND

Tel: 0161 245 1111 Email: manchestersg@thornleygroves.co.uk

Visit www.thornleygroves.co.uk for the latest listings

Century Buildings is an outstanding example of Victorian architectural design that still stands proud and appeals to those with both the traditional and modernist eye. The main part of the building has retained many period features with impressive communal areas. This delightful apartment has idyllic views over Parsonage Gardens and the accommodation briefly comprises: entrance hallway, open plan living room, integrated kitchen, two double bedrooms, en-suite shower room and main bathroom suite. The development benefits from a 24 hour concierge service and a highly sought after location just off Deansgate close to the city's many popular amenities. Secure valet parking included. Subject to Contract. EPC Rating - TBC.



Entrance Hallway

Living Room

18'7 x 15'2 (5.66m x 4.62m)

Kitchen

11'11 x 8'9 (3.63m x 2.67m)

Bedroom One

18'7 x 10'1 (5.66m x 3.07m)

En-Suite

7'5 x 5'1 (2.26m x 1.55m)

Bedroom Two

13'5 x 10'6 (4.09m x 3.20m)

Bathroom

7'5 x 5'6 (2.26m x 1.68m)



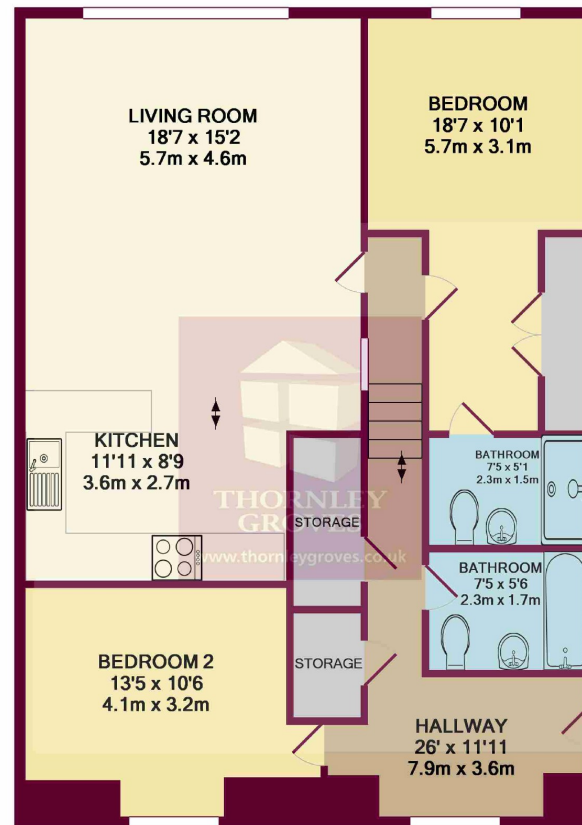

TOTAL APPROX. FLOOR AREA 877 SQ.FT. (81.5 SQ.M.)

Whilst every attempt has been made to ensure the accuracy of the floor plan contained here, measurements of doors, windows, rooms and any other items are approximate and no responsibility is taken for any error, omission, or mis-statement. This plan is for illustrative purposes only and should be used as such by any prospective purchaser. The services, systems and appliances shown have not been tested and no guarantee as to their operability or efficiency can be given
Made with Metropix ©2017

Thornley Groves do not test appliances or services in the property we are marketing, it is for the purchaser to carry out any checks they deem necessary prior to purchase. Nothing herein contained shall be warranty or condition and neither the vendor nor ourselves will be liable to the purchaser in respect of any misstatement or misrepresentation made at or before the date hereof by the vendor his servant agents or otherwise. Whilst every attempt has been made to ensure the accuracy of the floor plan, measurements of doors, windows, rooms and any other items are approximate and no responsibility is taken for any error, omission, or misstatement. The plan is for illustrative purposes only and should be used as such by any prospective purchaser.

Manchester Central
9 John Dalton Street M2 6FW
Tel: 0161 245 1111

Manchester Northern Quarter
84 Tib Street M4 1LG
Tel: 0161 245 1111

Manchester Southern Gateway
25 Whitworth St West M1 5ND
Tel: 0161 245 1111

Salford City Point
150 Chapel Street M3 6AF
Tel: 0161 245 1111

Swinton
46 Chorley Road M27 5AF
Tel: 0161 728 3358

Urmston
2 Higher Road M41 9BQ
Tel: 0161 748 4111

Sale
100 School Road M33 7XB
Tel: 0161 962 4111

Altrincham
16/18 Lloyd Street WA14 2DE
Tel: 0161 941 4111

Hale
213 Ashley Road WA15 9TB
Tel: 0161 941 4111

