



174 City Gate 2  
3 Blantyre Street  
Castlefield  
M15 4EG



- Castlefield Position
- Close to City Centre
- Nearby Transport Links
- Large Living Space

- Brand New Kitchen with Breakfast Bar and Integrated Dishwasher
- Two Double Bedrooms
- Parking Included

£229,950

25 Whitworth St West, Manchester, M1 5ND  
Tel: 0161 245 1111 Email: manchestersg@thornleygroves.co.uk

Visit [www.thornleygroves.co.uk](http://www.thornleygroves.co.uk) for the latest listings

A beautifully renovated two bedroom property situated within the modern and desirable development of City Gate 2. Positioned within the idyllic Castlefield the property benefits from being a short stroll to Deansgate and beyond whilst providing easy access to main transport links and the motorway network. Boasting an enviable position within the development with breathtaking views in to the City Centre from the large floor to ceiling windows. Inclusive of an allocated parking space, the excellently cared for property briefly comprises: entrance hallway, open plan living room, modern kitchen with breakfast bar, two double bedrooms & three piece bathroom suite. Subject to Contract. EPC Rating - C.





### Entrance Hallway

### Living Room

20'9 x 16'9 (6.32m x 5.11m)

### Kitchen

16'3 x 6'7 (4.95m x 2.01m)

### Bedroom One

16'3 x 12'9 (4.95m x 3.89m)

### Bedroom Two

16'9 x 7'7 (5.11m x 2.31m)

### Bathroom

7'8 x 6'9 (2.34m x 2.06m)



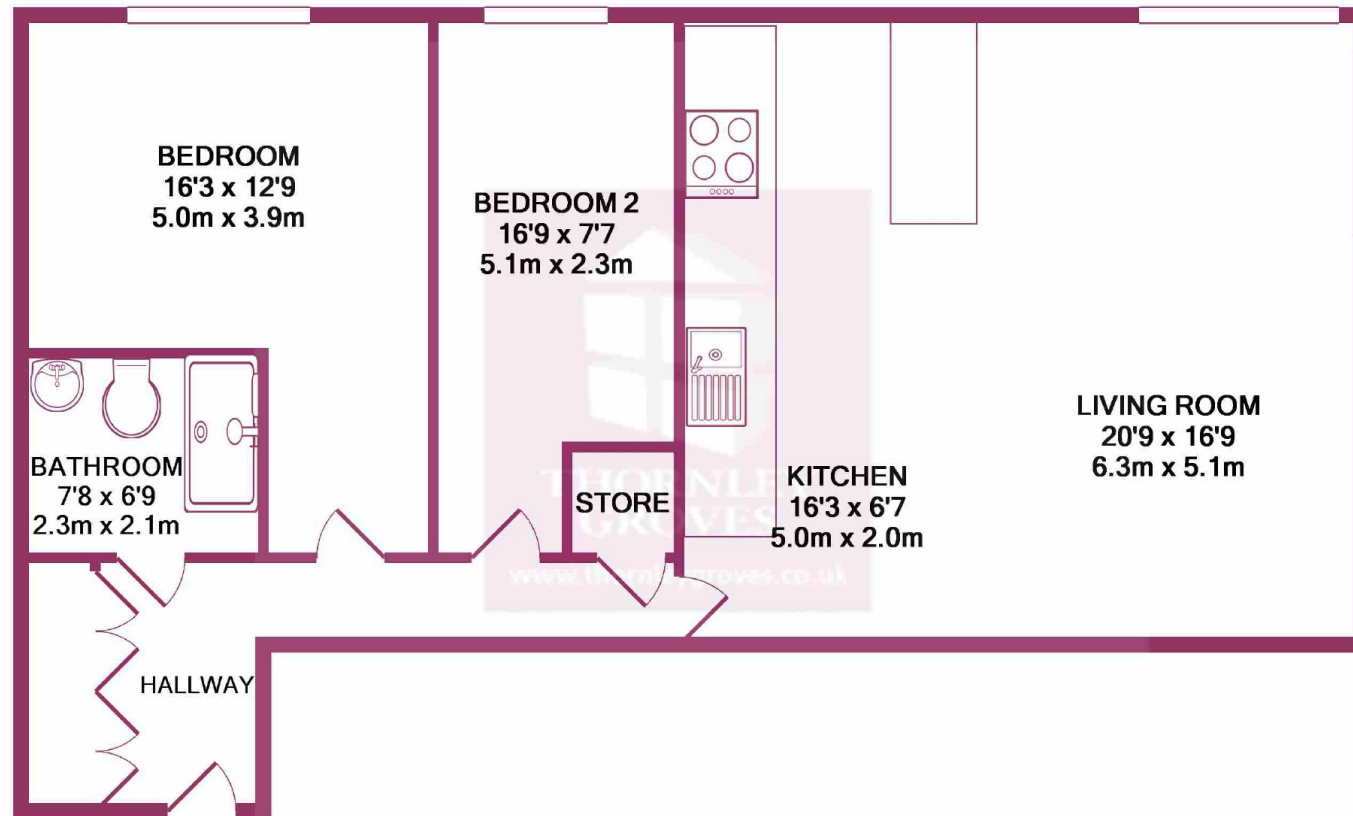

TOTAL APPROX. FLOOR AREA 842 SQ.FT. (78.3 SQ.M.)  
Measurements are approximate. Not to scale. Illustrative purposes only  
Made with Metropix ©2018

Thornley Groves do not test appliances or services in the property we are marketing, it is for the purchaser to carry out any checks they deem necessary prior to purchase. Nothing herein contained shall be warranty or condition and neither the vendor nor ourselves will be liable to the purchaser in respect of any misstatement or misrepresentation made at or before the date hereof by the vendor his servant agents or otherwise. Whilst every attempt has been made to ensure the accuracy of the floor plan, measurements of doors, windows, rooms and any other items are approximate and no responsibility is taken for any error, omission, or misstatement. The plan is for illustrative purposes only and should be used as such by any prospective purchaser.

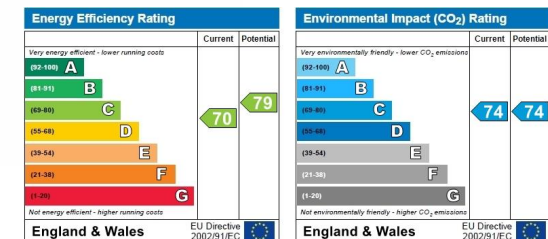

**Manchester Central**  
9 John Dalton Street M2 6FW  
Tel: 0161 245 1111

**Manchester Northern Quarter**  
84 Tib Street M4 1LG  
Tel: 0161 245 1111

**Manchester Southern Gateway**  
25 Whitworth St West M1 5ND  
Tel: 0161 245 1111

**Salford City Point**  
150 Chapel Street M3 6AF  
Tel: 0161 245 1111

**Swinton**  
46 Chorley Road M27 5AF  
Tel: 0161 728 3358

**Urmston**  
2 Higher Road M41 9BQ  
Tel: 0161 748 4111

**Sale**  
100 School Road M33 7XB  
Tel: 0161 962 4111

**Altrincham**  
16/18 Lloyd Street WA14 2DE  
Tel: 0161 941 4111

**Hale**  
213 Ashley Road WA15 9TB  
Tel: 0161 941 4111

