



GR 8 Grays Lane,  
Dundee DD2 3AN

Fixed Price £64,000

- Popular central location
- Ground Floor position
- Security Entry System
- Large Lounge
- Two Double Bedrooms
- Bathroom
- Kitchen
- Well Tended Communal Gardens



Set within a small, traditional styled block of similar properties, this spacious ground floor apartment provides an excellent opportunity as a first time buy or buy to let investment.

The accommodation comprises; well tended communal entrance hall with secure entry system access which gives access to the flat, entrance hall, spacious lounge, two excellent sized double bedrooms, well presented family bathroom and a kitchen.

The subjects are in tasteful decorative order benefiting from gas central heating and double glazing. A wide range of excellent local amenities includes Ninewells Teaching Hospital, schools, shops and further services at city centre including both Universities are within easy access. There is a well kept shared garden to the rear. EPC D

Lounge	15'8 x 14'8	(4.78m x 4.47m)
Kitchen	11'2 x 6'1	(3.40m x 1.85m)
Bathroom	6'9 x 5'11	(2.06m x 1.80m)
Bedroom 1	15'0 x 12'2	(4.57m x 3.71m)
Bedroom 2	11'2 x 9'1	(3.40m x 2.77m)

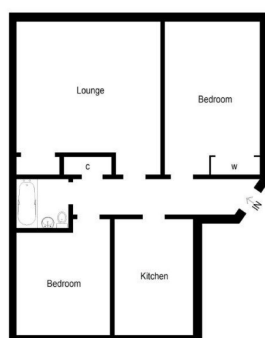

Illustration For Identification Purposes Only.  
Not To Scale (ID:400959 / Ref:53696)

Thorntons is a trading name of Thorntons LLP. Note: While Thorntons make every effort to ensure that all particulars are correct, no guarantee is given and any potential purchasers should satisfy themselves as to the accuracy of all information. Floor plans or maps reproduced within this schedule are not to scale, and are designed to be indicative only of the layout and location of the property advertised.

T: 03330 430090 | E: [genea@thorntons-law.co.uk](mailto:genea@thorntons-law.co.uk) | [www.thorntons-property.co.uk](http://www.thorntons-property.co.uk)

Dundee | Anstruther | Arbroath | Cupar | Edinburgh | Forfar | Kirkcaldy | Montrose | Perth | St Andrews

