



2 Rose Gardens, Highcliffe, BH23 4FW

PETTENGELLS
ESTATE AGENTS

2 Rose Gardens, Highcliffe, BH23 4FW

- Nearly new detached house
- Luxury fitted kitchen/diner with Porcelanosa ceramic tiled floors & integrated appliances
- Quartz worktops
- Four first floor bedrooms
- Luxury fitted bathroom
- En-suite to main bedroom
- Presented in first class condition
- Underfloor heating to ground floor
- Two allocated parking spaces
- Convenient for local shops & transport connections
- Council Tax: Band E
- EPC Rating: Band B



£495,000



ALMOST NEW - A FOUR BEDROOM CONTEMPORARY STYLE HOME, forming part of an exclusive development on the edge of Highcliffe Village within easy reach of Mudeford Harbour and the beaches at Friars Cliff.

Constructed in 2017, this property was designed to create a bright and vibrant feel with a contemporary layout.

With accommodation comprising: Reception hall, ground floor cloakroom, superb kitchen/diner with double opening doors onto living room. Four first floor bedrooms with an en-suite shower to the main bedroom and a family bathroom.

Externally, there is block paved parking for two vehicles to the front of the property and a rear garden enclosed behind fencing, majority laid to lawn with patio.

GROUND FLOOR

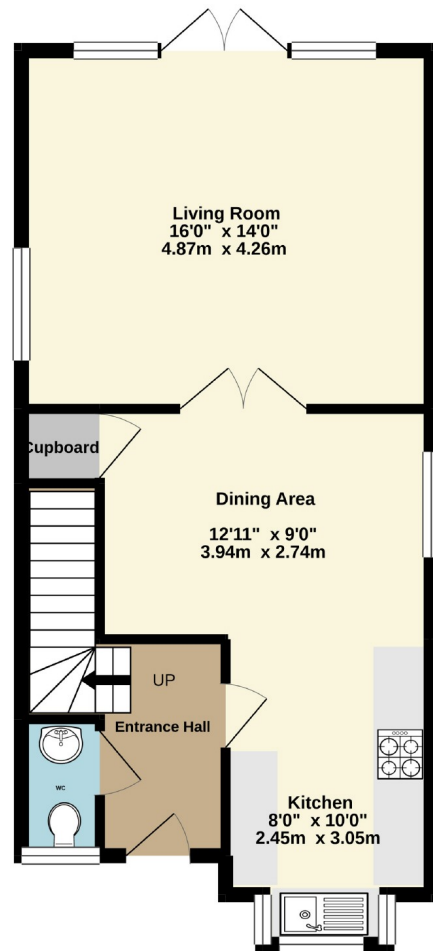

1ST FLOOR

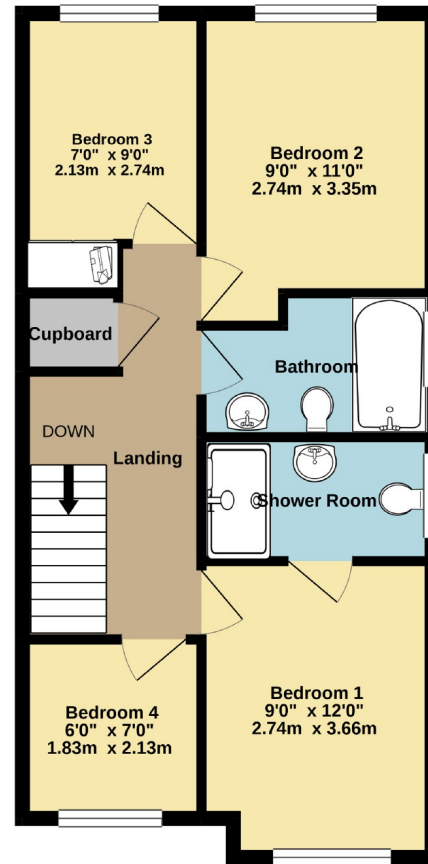

Whilst every attempt has been made to ensure the accuracy of the floorplan contained here, measurements of doors, windows, rooms and any other items are approximate and no responsibility is taken for any error, omission or mis-statement. This plan is for illustrative purposes only and should be used as such by any prospective purchaser. The services, systems and appliances shown have not been tested and no guarantee as to their operability or efficiency can be given.
Made with Metropix ©2021

