



1 Tresillian Way, Walkford, BH23 5QP

**PETTENGELLS**  
ESTATE AGENTS



# 1 Tresillian Way, Walkford, BH23 5QP

- Modern well proportioned house
- Three/four bedrooms
- Generous kitchen/diner with integrated appliances
- En-suite to main bedroom
- Family bathroom
- Ground floor cloakroom
- Living room opening onto conservatory
- Block paved driveway providing ample off road parking
- Close proximity to local shops
- Highcliffe schools catchment
- EPC Rating: Band B
- Council Tax: Band E



**£550,000**





**A MODERN AND WELL PROPORTIONED THREE/FOUR BEDROOM DETACHED HOUSE**, ideally located for local shops and within Highcliffe schools catchment area

Constructed in 2017 this spacious home has accommodation comprising: Generous kitchen/dining room, located at the front of the house and which has a range of modern eye and base level units including a centre island and integrated appliances, living room opening onto conservatory, ground floor study/bedroom four and a cloakroom. On the first floor there are three bedrooms with ensuite to the main bedroom and a family bathroom. Externally, there is a small front garden and block paved driveway giving ample off road parking with a well stocked rear garden enclosed behind fencing, small lawned area.

GROUND FLOOR

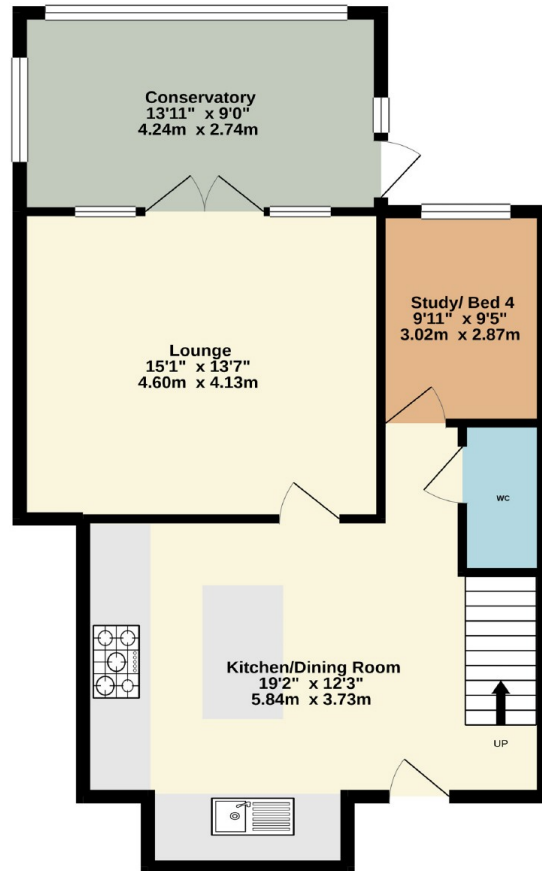

1ST FLOOR

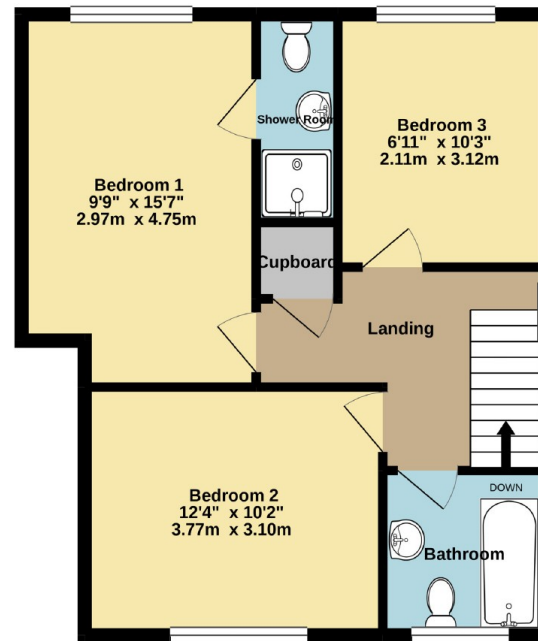

Whilst every attempt has been made to ensure the accuracy of the floorplan contained here, measurements of doors, windows, rooms and any other items are approximate and no responsibility is taken for any error, omission or mis-statement. This plan is for illustrative purposes only and should be used as such by any prospective purchaser. The services, systems and appliances shown have not been tested and no guarantee as to their operability or efficiency can be given.  
Made with Metropix ©2021

