



# SIGNATURE

by Mark Small

NORTH EAST



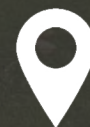

THE CHASE, BEDLINGTON,  
NE22 6BY



# The Chase, Bedlington, NE22 6BY

A fantastic opportunity has arisen to the market to acquire this beautifully presented four bedroom town house, ideally positioned within the popular residential area of Bedlington. Built in 2009, this freehold property boasts extensive living space over three floors, with a total floor area of 1369 square feet.

A welcoming hallway provides access into the principal rooms of the ground floor, beginning with a well presented dining room which offers a large bay window overlooking the front of the property. To the rear of the hallway there is a spacious, open plan kitchen/family area which offers ample sitting space. The kitchen area itself benefits from modern fitted units for storage, as well as an integrated oven, hob and extractor fan. French doors lead out into to the rear courtyard. There is also a convenient WC.

To the first floor of the property there is the extensive living room which showcases stunning decor and access to a Juliette balcony and the large master bedroom which benefits from fitted storage space and an en-suite shower room.

The second floor is home to the remaining three generously sized bedrooms, one of which also has fitted storage space and an en-suite. Completing this impressive home is a three piece family bathroom, with a Velux window for additional natural light during the day.

Externally, there are two allocated parking spaces included with the property, and to the rear of the home is a low maintenance courtyard, offering paved sitting areas and bordering shrubbery.

The property is also close to the A189 Spine Road. The local schooling is highly regarded within the area and is ideal for a family, with schools such as: St Bede's CVA Primary School, West End First School, Meadowdale Academy and St Benet Biscop Academy. There is an abundance of local amenities and great transportation links to the surrounding towns and to Newcastle City Centre.

**Offers over £169,950**



# Property Floorplan

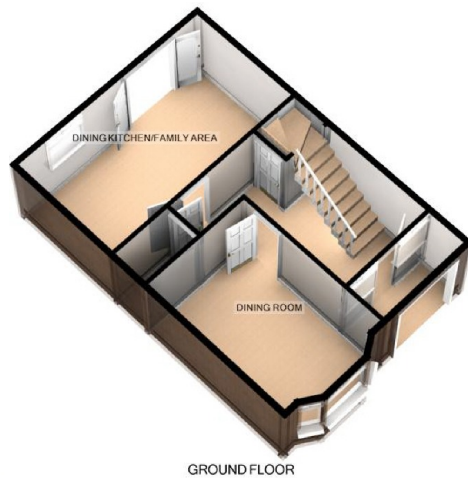

GROUND FLOOR

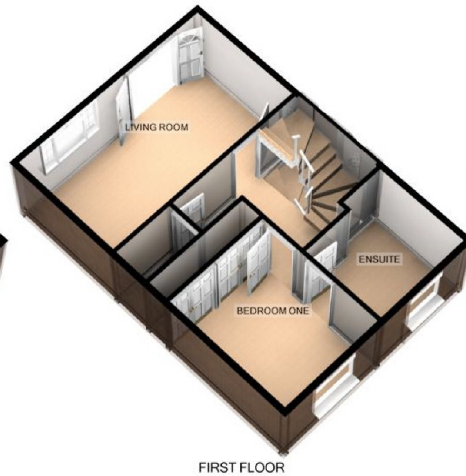

FIRST FLOOR

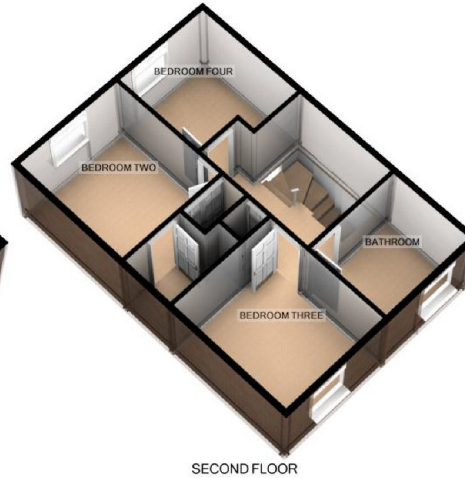

SECOND FLOOR

THE CHASE, BEDLINGTON

For illustrative purposes only. Decorative finishes, fixtures, fittings and furnishings do not represent the current state of the property. Measurements are approximate. Not to scale  
Made with Metropix ©2018

## Measurements:

DINING ROOM 13'2 X 8'4

KITCHEN 9'8 X 7'11

FAMILY AREA/DINING 16'0 X 9'8

WC 5'2 X 3'2

LIVING ROOM 16'10 X 9'10

BEDROOM ONE 11'4 X 9'6

EN-SUITE 7'0 X 6'8

BATHROOM 7'6 X 3'3

BEDROOM TWO 11'0 X 9'6

EN-SUITE 6'9 X 4'8

BEDROOM THREE 10'10 X 9'6

BEDROOM FOUR 9'10 X 7'0

BATHROOM 7'4 X 7'0

**EPC Rating C**





NO.1 AGENT IN THE NORTH EAST





"From organizing our first viewing to handing over the keys, we found the staff at Signature very professional and helpful. Finding a new home can be a stressful experience but we felt the service at Signature was smooth and hassle free." - Michelle

"I recently let my property through Signature. Every member of the team that I dealt with were friendly, professional and efficient." - Barry

**TOP RATED ON ALLAGENTS.CO.UK**

---

THE LARGEST  
NORTH EAST HYBRID  
ESTATE AGENCY WITH  
HIGH END BRANCHES

---

## OUR LOCATIONS

Whitley Bay - 0191 251 3344  
Tynemouth - 0191 296 6689  
Whickham - 0191 432 5102  
Jesmond - 0191 281 1037  
Newcastle - 0191 640 2284  
Ponteland - 01661 820 082

Gosforth - 0191 640 3523  
Wallsend - 0191 432 4151  
Heaton - 0191 432 4275  
Cramlington - 01670 897 213  
Morpeth - 01670 897 155  
Forest Hall - 0191 2669 966

Gateshead - 0191 432 4294  
Killingworth - 0191 640 3602  
Durham - 0191 303 8252  
Sunderland - 0191 543 6390  
Alnwick - 01665 511 800  
Ryton - 0191 4139 845