



Swallow House, Epsom, KT19 0AF





£335,000

## Leasehold

- Two double bedrooms
- First floor apartment
- Contemporary & stylish
- Living/Dining/Kitchen Area
- Contemporary kitchen
- Luxury bathroom
- Ensuite shower room
- Ideal Investment Or FTB
- Fitted Wardrobes
- Private Balcony

Set within a popular modern development built by Riverdale homes, this well proportioned first floor apartment enjoys direct access to a private balcony and an excellent position within this small cul de sac within walking distance of both Ewell West Station & Tolworth Station, not to mention the Ruxley Lane shops & Sports Direct Gym .

Perfect as an investment or first time buy, or perhaps a bolt-hole for those wanting to downsize but not downgrade, this two double bedroom apartment benefits from spacious accommodation and an abundance of natural light.

Immediate viewing is absolutely essential to fully appreciate this particularly well balanced apartment.



The apartment has a video security entry phone and benefits further from a secure communal entrance. The property comprises a spacious open plan living area with double doors to the balcony, open plan fitted kitchen with integrated appliances and granite work surfaces, impressive master bedroom with built-in wardrobes and ensuite shower room, second double bedroom and modern white bathroom suite.

Further noteworthy points to mention include use of the communal gardens, allocated parking space and a true community feel throughout the block.

Ewell Village offers a variety of shops, restaurants, cafés and pubs. Bourne Hall hosts a public library, subterranean theatre, gymnasium, café, and local museum. It regularly holds gatherings such as fayres.

In the heart of the village lies the Hogsmill river leading up to the nature reserve. There are a range of popular local schools and of course both Ewell East and West stations with their connections to London.

Leasehold







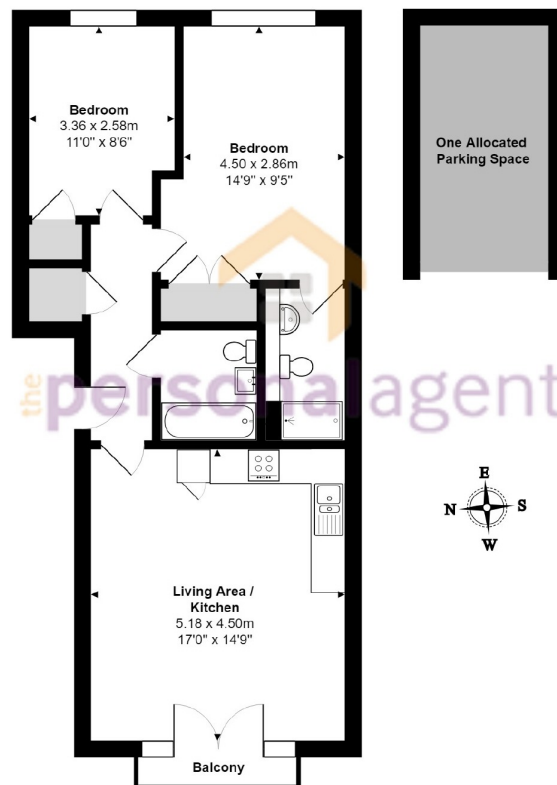

Swallow House, Merchant Close, Ewell

Total Area: 62.9 m<sup>2</sup> ... 677 ft<sup>2</sup> (excluding balcony, one allocated parking space)

FOR ILLUSTRATIVE PURPOSES ONLY.

Whilst every attempt has been made to ensure the accuracy of the floor plan shown, all measurements, positioning, fixtures, features, fittings and any other data shown are an approximate interpretation for illustrative purposes only and are not to scale.

No responsibility is taken for any error, omission, miss-statement or use of data shown.

The above statement applies to both 'Still Moving London LTD' and the Company or individual displaying this floor plan.

Unauthorised reproduction prohibited.

© Still Moving London LTD (www.stillmoving.london)



Please Note: Whilst every attempt has been made to ensure the accuracy of the floorplans contained here, measurements of doors, windows and room areas are approximate and no responsibility is taken for any error, omission or mis-statement. These plans are for representation purposes only and should be used as such by and prospective purchaser. The services, systems and appliances listed in the specification have not been tested by The Personal Agent and no guarantee as to their operating ability or their efficiency can be given. All images and text used to advertise our properties are for the sole use of The Personal Agent Ltd.



2 West Street, Epsom, Surrey, KT18 7RG, England

Tel: 01372 745850

Email: richard@thepersonalagent.co.uk

www.thepersonalagent.co.uk





