



Rollesby Road, Chessington





£485,000

## Freehold

4 Bedroom House  
Extended End Of Terrace  
Accommodation of over 1300 SqFt  
67ft Rear Garden  
22ft Kitchen Diner  
2 Further Reception Rooms  
Off Street Parking  
Downstairs W/C & Upstairs Bathroom

A superb opportunity to acquire this four bedroom end of terrace home situated in a sought after location, close to Horton Country Park with its nature walks and acres of woodland.

Offering off street parking, private rear garden and spacious accommodation this home is sure to appeal to a wide range of buyers.

Call now to arrange your viewing - 0208 394 1234



The property comprises an 18ft x 15ft reception room with double doors opening to a further reception room with access to the downstairs W/C. A 22ft kitchen diner across the rear of the property with double doors opening to the rear garden. Upstairs there are 4 bedrooms, all served by the family bathroom. Outside, to the front there is a driveway providing parking for several cars and to the rear the garden measures 67ft.

The location is perfect for everybody, especially if you are looking for easy access to both the M25 or A3, and a great selection of primary & secondary schools within walking distance for the property.

Chessington offers rail links into London Waterloo and Clapham Junction, with further links to most major stations. Close to the A3 and M25 Chessington is an ideal spot for those who drive into the city or work within the Home Counties. Surrounded by parks in the London Borough of Kingston and Epsom & Ewell Boroughs making it an attractive spot for families. As well as containing an abundance of Primary and Secondary schools making this small yet under-estimated part of the London Borough of Kingston Upon Thames a hidden gem for families and couples alike.







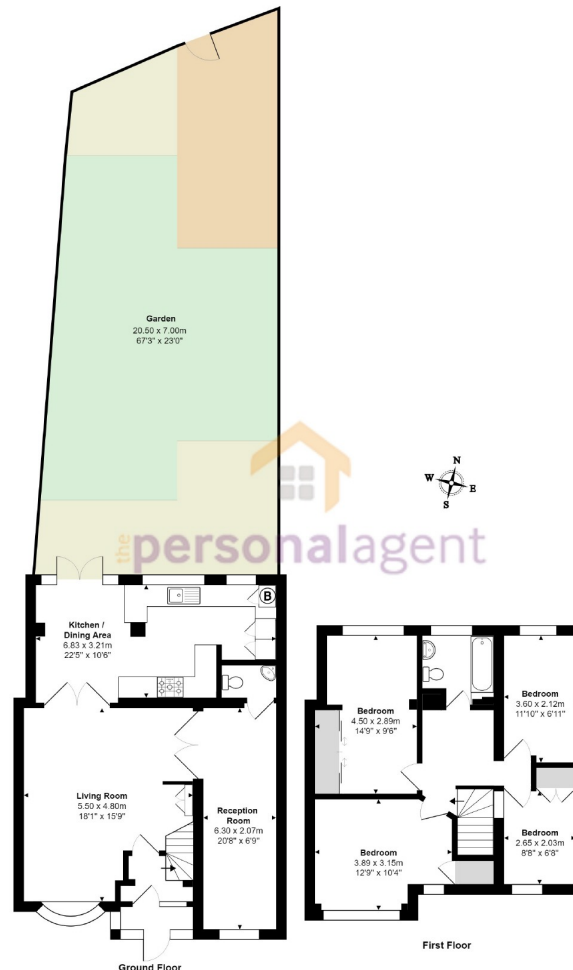

Rollesby Road, Chessington  
Total Area: 121.3 m<sup>2</sup> ... 1305 ft<sup>2</sup> (excluding garden)  
FOR ILLUSTRATIVE PURPOSES ONLY

Whilst every attempt has been made to ensure the accuracy of the floor plan shown, all measurements, positioning, fixtures, features, fittings and any other data shown are an approximate interpretation for illustrative purposes only and are not to scale.

No responsibility is taken for any error, omission, mis-statement or use of data shown.

The above statement applies to both Still Moving London LTD and the Company or individual displaying this floor plan.

Unauthorised reproduction prohibited.

© Still Moving London LTD (www.stillmoving.london)

the personal agent

Please Note: Whilst every attempt has been made to ensure the accuracy of the floorplans contained here, measurements of doors, windows and room areas are approximate and no responsibility is taken for any error, omission or mis-statement. These plans are for representation purposes only and should be used as such by and prospective purchaser. The services, systems and appliances listed in the specification have not been tested by The Personal Agent and no guarantee as to their operating ability or their efficiency can be given. All images and text used to advertise our properties are for the sole use of The Personal Agent Ltd.



141 High Street, Banstead, Surrey, SM7 2NS  
Tel: 01737 333699  
Email: [rupert@thepersonalagent.co.uk](mailto:rupert@thepersonalagent.co.uk)





