



APPROXIMATELY 473 SQ FT

### Description

An opportunity to lease a large retail unit located on the High Street in Starbeck with a prominent frontage. Internally the property has been left in a neutral condition with plaster painted walls and carpet throughout. The space currently offers an open plan sales floor with an office/storage space to the rear. Benefits include both WC and kitchenette facilities.

The property offers a rare double frontage onto the High Street and is located on the corner facing Starbeck railway crossing offering an excellent street presence. An early viewing would be strongly recommended to any party looking for a prominent retail premises on Starbeck High Street.

**DOUBLE-FRONTED RETAIL  
UNIT**

**£11,500**  
Per annum

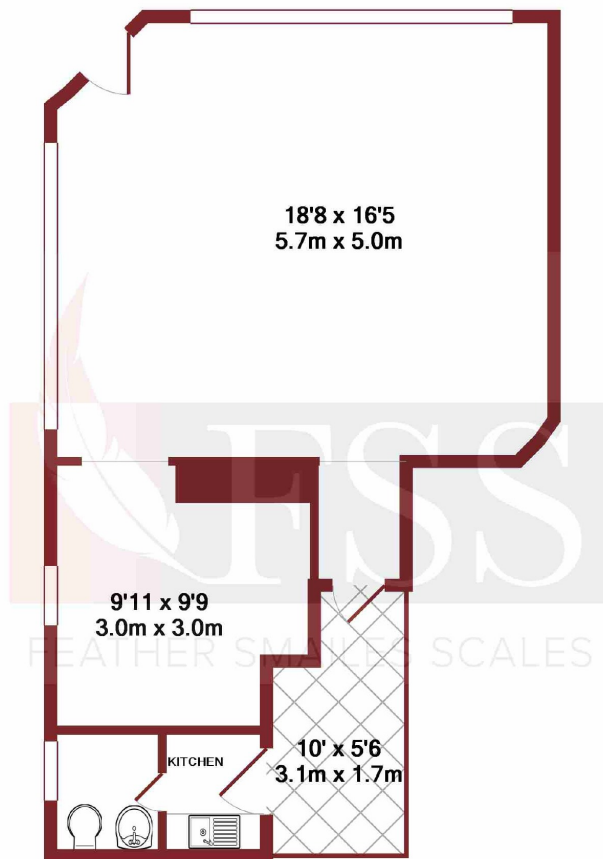

TOTAL APPROX. FLOOR AREA 439 SQ.FT. (40.8 SQ.M.)  
Made with Metropix ©2017

## Location

The subject premises is located in a prominent position on Starbeck High Street, in close proximity to the train Station/ railway line. Other local occupiers include The Stove Gallery, Staiano Motorcycles and KFC among others. The location of the unit allows for excellent Road links both into Harrogate Town Centre and beyond.

## Tenure

Leasehold. The property is available on a new lease the terms of which are to be

negotiated.

## Rateable Value

Rateable Value: £9,400

Uniform Business Rate for 2017/17 £0.479.

Small business rate relief may be available to some occupiers. Further enquiries should be directed to HBC 01423 500600

## VAT

All figures quoted are deemed exclusive of VAT where applicable.

## Costs

Unless expressly stated all parties will be responsible for

their own legal costs in connection with this transaction.

## Planning

Interested parties are advised to make their own enquiries of the local planning authority in respect of planning proposals if any change of use is envisaged.

## Services

All mains services are connected to the property.

## Viewing

Strictly by appointment with the agent Tel: 01423 501211

**IMPORTANT NOTICE: 1. Particulars:** These particulars are not an offer of contract, nor part of one. You should rely on Statements by Feather Smales Scales LLP in the particulars or by word of mouth or in writing ("information") as being factually accurate about the property, its condition or its value. Neither Feather Smales Scales or any joint agent has any authority to make any representations about the property, and accordingly any information given is entirely without responsibility on the part of the agents, seller(s) or lessor(s). **2. Photos etc:** The measurements and distances given are approximate only and maps and plans displayed are for illustration purposes only. photographs show only certain parts of the property as they appeared at the time they were taken. Areas, **3. Regulations etc:** Any reference to alterations to, or use of, any part of the property does not mean that any necessary planning, building regulations or other consent has been obtained. A buyer or lessee must find out by inspection or in other ways that these matters have been properly dealt with and that all information is correct. **4. VAT:** The VAT position relation to the property may change without notice. Viewing by appointment only. Feather Smales & Scales is a limited liability registered in England with registered number OC308783. Our registered office is 8 Raglan Street, Harrogate, North Yorkshire, HG1 1LE, where you may look at a list of members' names.

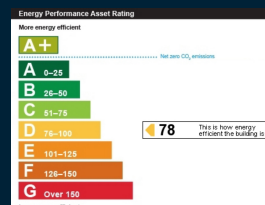

**01423 501 211**

[www.fssproperty.co.uk](http://www.fssproperty.co.uk)

[info@fssproperty.co.uk](mailto:info@fssproperty.co.uk)

8 Raglan Street, Harrogate,  
North Yorkshire, HG1 1LE