





## Description

A superbly presented, completely re-furbished two bedroom ground floor apartment, which is ready for immediate occupation. The property has undergone a re-wire, brand new gas fired central heating system, full replacement UPVC sealed unit double glazing, brand new kitchen with integrated oven and hob and stylish bathroom with corner bath and separate shower cubicle.

There is the possibility of creating parking as this property owns the area in front up to the channel in the pavement.

The apartment occupies the ground floor of this attractive Victorian building and is situated on the corner of Knaresborough Road and Newnham Terrace. The immediate area supports a good range of amenities catering for most daily needs, with the town centre only a short distance away.

Also within close proximity is the 200 acre Stray and Hospital, which could make this an ideal investment property for the rental market.

## Tenure

Leasehold. Remainder of a 999 year lease.

## Ground Rent

Peppercorn

## Services

All mains services are connected to the property.

## Directions

From Station Parade proceed to the traffic lights adjoining York Place. Turn left and proceed to the Empress roundabout, go straight over on to Knaresborough Road, where the property will be seen on your right hand side.

## Details Prepared

25/06/18





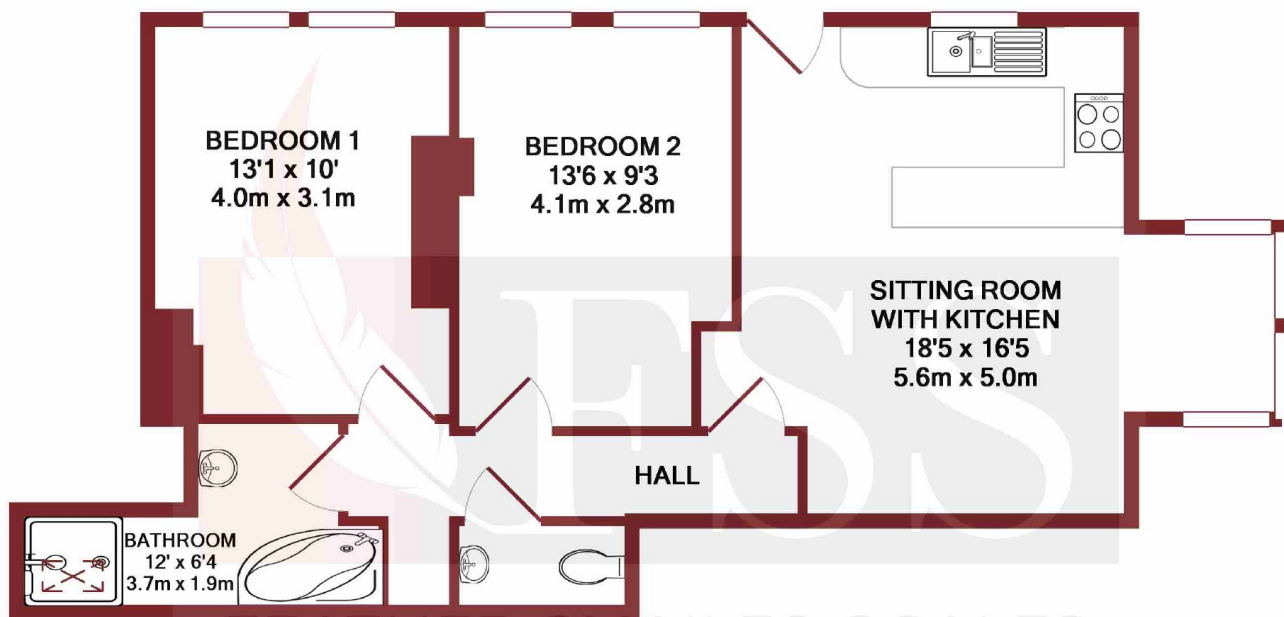

**TOTAL APPROX. FLOOR AREA 601 SQ.FT. (55.8 SQ.M.)**  
Made with Metropix ©2018

**IMPORTANT NOTICE: 1. Particulars:** These particulars are not an offer of contract, nor part of one. You should reply on Statements by Feather Smalles Scales LLP in the particulars or by word of mouth or in writing ("information") as being factually accurate about the property, its condition or its value. Neither Feather Smalles Scales or any join agent has any authority to make any representations about the property, and accordingly any information given is entirely without responsibility on the part of the agents, seller(s) or lessor(s). **2. Photos etc:** The measurements and distances given are approximate only and maps and plans displayed are for illustration purposes only. photographs show only certain parts of the property as they appeared at the time they were taken. Areas, **3. Regulations etc:** Any reference to alterations to, or use of, any part of the property does not mean that any necessary planning, building regulations or other consent has been obtained. A buyer or lessee must find out by inspection or in other ways that these matters have been properly dealt with and that all information is correct. **4: VAT:** The VAT position relation to the property may change without notice. Viewing by appointment only. Feather Smalles & Scales is a limited liability registered in England with registered number OC308783. Our registered office is 8 Raglan Street, Harrogate, North Yorkshire, HG1 1LE, where you may look at a list of members' names.

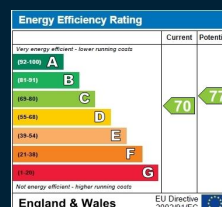

**01423 501 211**

[www.fssproperty.co.uk](http://www.fssproperty.co.uk)  
[info@fssproperty.co.uk](mailto:info@fssproperty.co.uk)  
8 Raglan Street, Harrogate,  
North Yorkshire, HG1 1LE

**rightmove**  
find your happy

**OnTheMarket.com**

**TDS**  
Tenancy Deposit Scheme  
member

**nava | propertymark**  
PROTECTED

**aria | propertymark**  
PROTECTED

**naea | propertymark**  
PROTECTED

**The Property Ombudsman**