



**Broomsleigh Street
West Hampstead, NW6 1QH**

Kitchen/Reception	Bedroom 2
21'11 x 11'11	14'1 x 11'5
6.68m x 3.63m	4.29m x 3.48m

Dining Room
10'9 x 7'5
3.28m x 2.26m

Bedroom 1
14'1 x 11'7
4.29m x 3.53m

A two double bedroom GARDEN FLAT in West Hampstead.

This flat has recently been refurbished and provides a superb open plan living-dining room and two double bedrooms and the private garden which wraps around the flat.

This property is conveniently located within a short walk from West Hampstead Jubilee, Overground and Thameslink stations.

Available from the 17th of August 2018 and offered furnished.

£425 Per Week
Fees apply



Energy Efficiency Rating		Current	Potential
Very energy efficient - lower running costs			
(92-100) A			
(81-91) B			
(69-80) C			
(55-68) D			
(39-54) E			
(21-38) F			
(1-20) G			
Not energy efficient - higher running costs			
England & Wales		43	67
		EU Directive 2002/91/EC	

Environmental Impact (CO ₂) Rating		Current	Potential
Very environmentally friendly - lower CO ₂ emissions			
(92-100) A			
(81-91) B			
(69-80) C			
(55-68) D			
(39-54) E			
(21-38) F			
(1-20) G			
Not environmentally friendly - higher CO ₂ emissions			
England & Wales		40	66
		EU Directive 2002/91/EC	

Broomsleigh Street, London, NW6

APPROX. GROSS INTERNAL FLOOR AREA 733 SQ FT 68 SQ METRES

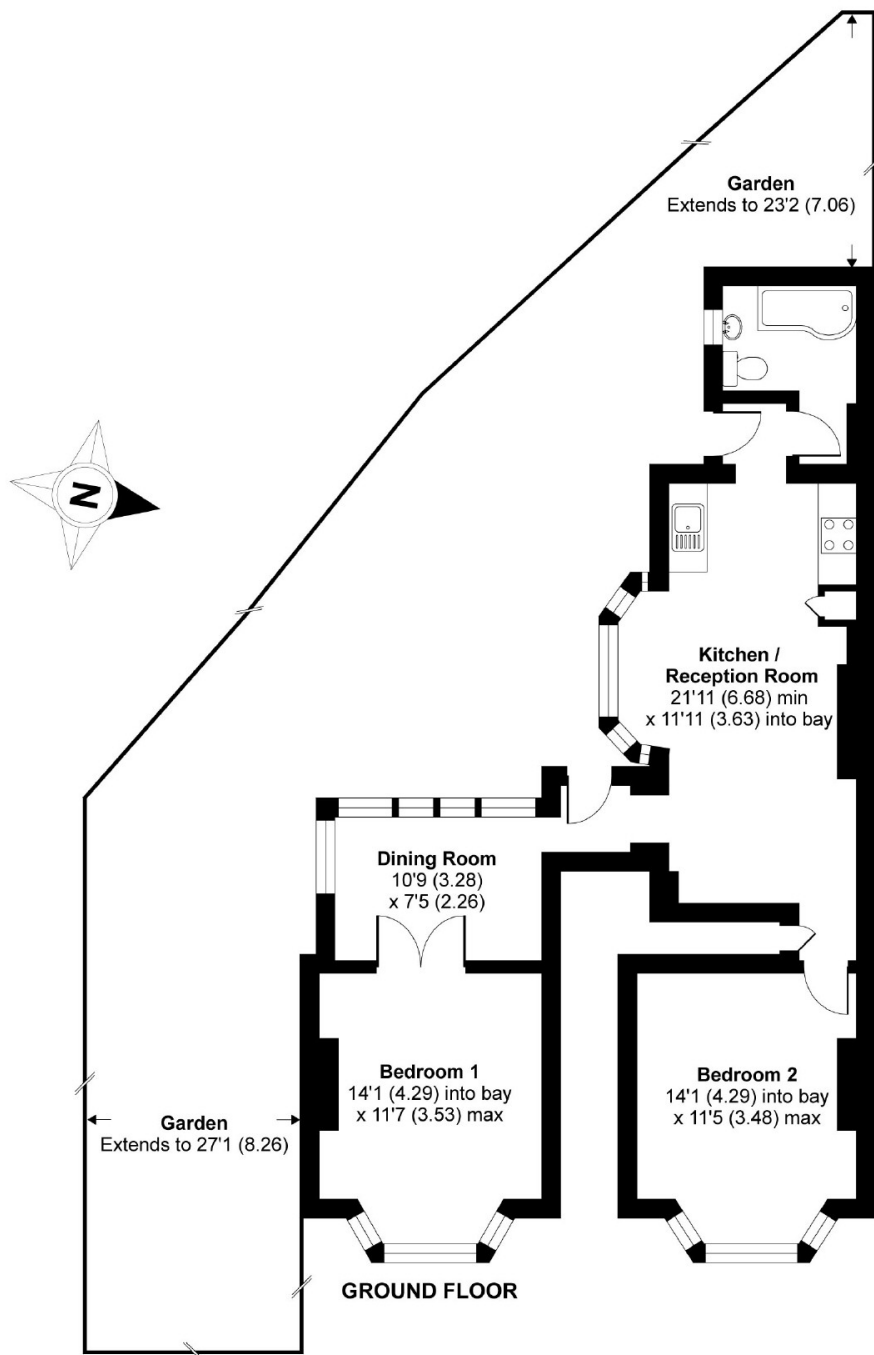

Whilst every attempt has been made to ensure the accuracy of the floor plan contained here, measurements of doors, windows and rooms are approximate and no responsibility is taken for any error, omission or misstatement. These plans are for representation purposes only as defined by RICS Code of Measuring Practice and should be used as such by any prospective purchaser. Specifically no guarantee is given on the total square footage of the property if quoted on this plan. Any figure given is for initial guidance only and should not be relied on as a basis of valuation.

Copyright nichecom.co.uk 2013 Produced for Dutch & Dutch REF : 410603