



Apt 6, 51 Allesley Old Road, Coventry, CV5 8EH

Asking price £179,500





Apt 6, 51 Allesley Old Road, Coventry, CV5 8EH

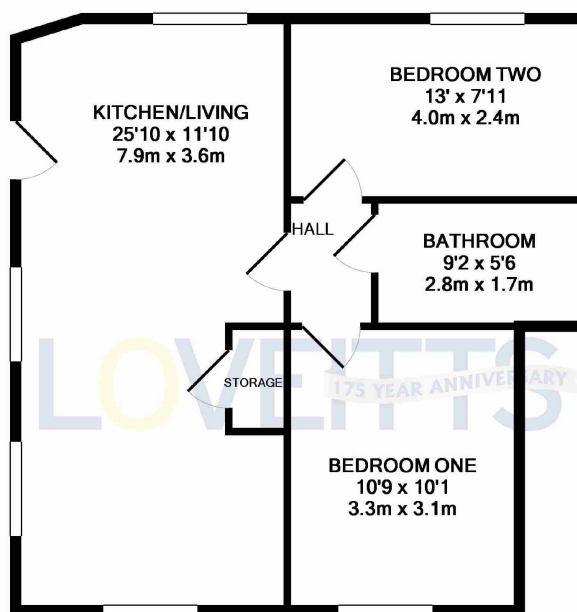

TOTAL APPROX. FLOOR AREA 604 SQ.FT. (56.1 SQ.M.)

Whilst every attempt has been made to ensure the accuracy of the floor plan contained here, measurements of doors, windows, rooms and any other items are approximate and no responsibility is taken for any error, omission, or mis-statement. This plan is for illustrative purposes only and should be used as such by any prospective purchaser. The services, systems and appliances shown have not been tested and no guarantee as to their operability or efficiency can be given

Made with Metropix ©2018

Situated in a fantastic and convenient location are these high spec, fresh newly built first floor apartments. Located in Chapelfields on the corner of Allesley Old Road and Lord Street, only a short distance away from the Coventry City Centre,

The apartment has been finished to a high standard and comprises: A stunningly bright and airy open plan kitchen/ living room, two bedrooms and a bathroom.

Further benefits include double glazing and an allocated parking space.

As the sellers agent we are not surveyors or conveyancing experts and as such we cannot and do not comment on the condition of the property or issues relating to title or other legal issues that may affect this property, unless we have been made aware of such matters. Interested parties should employ their own professionals to make such enquiries before making any transactional decisions.

Kitchen/Living

25'10 x 11'10 (7.87m x 3.61m)

Bedroom One

10'9 x 10'1 (3.28m x 3.07m)

Bedroom Two

13' x 7'11 (3.96m x 2.41m)

Bathroom

9'2 x 5'6 (2.79m x 1.68m)

Allocated Parking Space

