



Carlton Hill, NW8

£600 Per week

A bright and spacious top-floor, two-double-bedroom flat in this popular purpose-built block, ideally situated between St Johns Wood and Maida Vale. The sunny living room features elegant parquet wood flooring, while both double bedrooms have fitted wardrobes. The separate kitchen includes a breakfast bar and integrated appliances, including a dishwasher. The bathroom is fitted with a shower over the bath.

Elmfield House is on the popular Carlton Hill and is conveniently located between the sought-after Hamilton Terrace and the famous Abbey Road. St John's Wood and Maida Vale Underground stations are both within 0.5 miles

Features

- Two Double Bedrooms
- Bright Living/Dining Room
- Parquet Wood Floors
- Popular Road
- Separate Kitchen
- Managed By Dexters

Carlton Hill, London, NW8

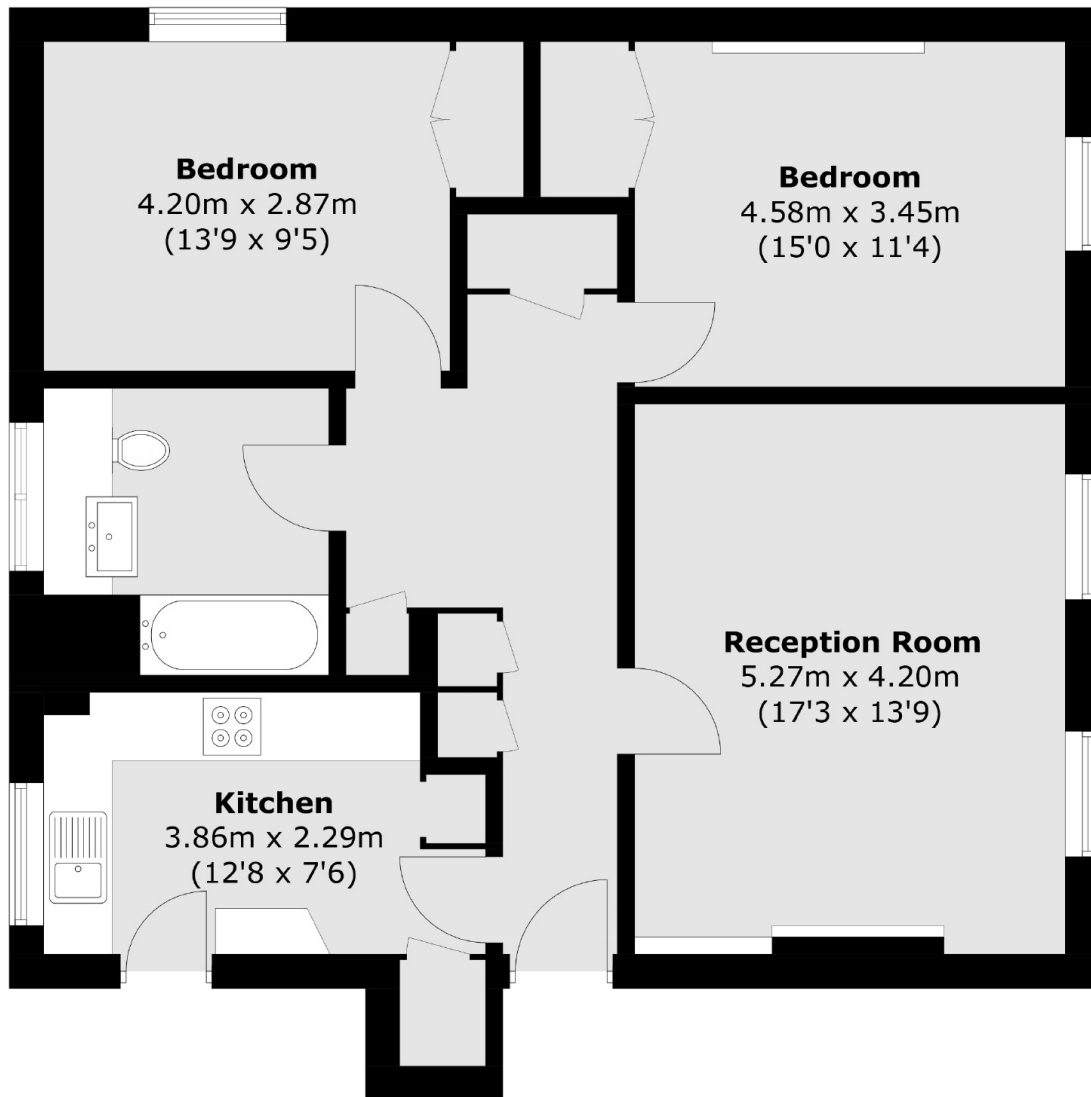

Total area (approx.): 72.2 sq. m (777.2 sq. ft)