

Grove End Road, NW8

£542 Per week

A recently refurbished one double bedroom apartment on the third floor of a 24 hour portered block. Bright reception room with wood floors, separate modern kitchen, good size double bedroom with built in storage and bathroom. Ideal home for a single professional or couple. Rent includes communal heating and hot water.

Grove End Gardens is located a short distance from St Johns Wood Underground Jubilee Line Station and all local shops and restaurants on High Street.

Features

Recently Refurbished
One Bedroom Apartment
Third Floor With Lift
Communal Heating and Hot Water
24 Hour Porter
Communal Garden

Grove End Road,
London, NW8

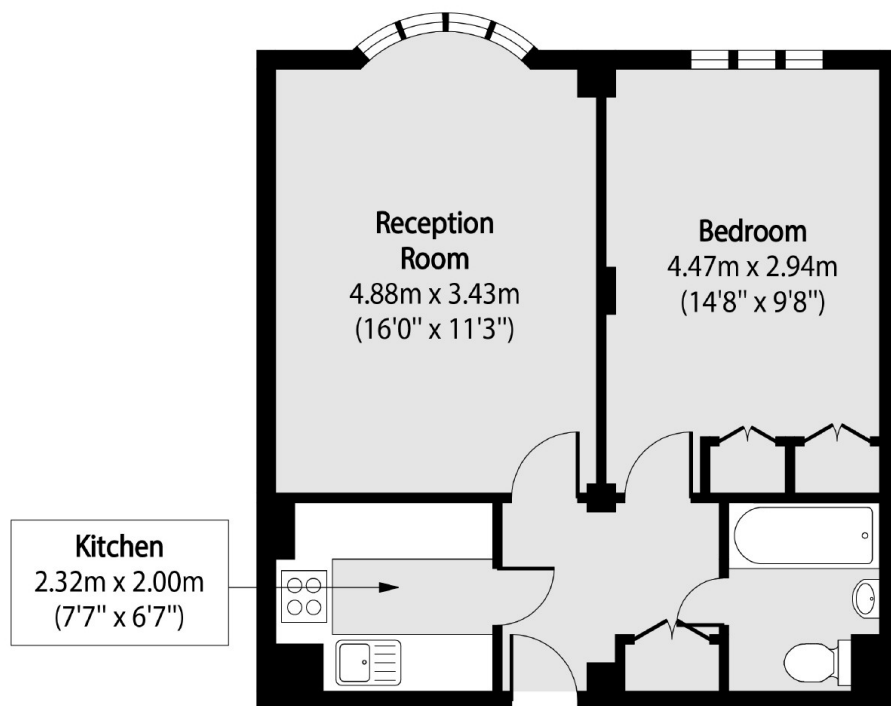

Total area (approx): 42.29 sq m (455 sq. ft)

Dexters

St. John's Wood
4-6 St Ann's Terrace
London
NW8 6PJ
Lettings
020 7483 6330

Energy Rating: C. We aim to make our particulars both accurate and reliable. However they are not guaranteed; nor do they form part of an offer or contract. If you require clarification on any points then please contact us, especially if you're traveling some distance to view. Please note that appliances and heating systems have not been tested and therefore no warranties can be given as to their good working order.

RICS Regulated
Estate Agent
and Letting Agent

dexters.co.uk