



, W9

£599,999

A top floor flat available with two double bedrooms, an open plan kitchen living room and a family bathroom. Configured with study space on the landing and with a long leasehold.

Portnall Road is less than half a mile from Queen's Park and all the amenities on Salusbury Road as well as within a mile of Portobello and Westbourne Park.

Features

Two Double Bedrooms
Top Floor Flat
Open Plan
Wooden Floors
Period Conversion
Leasehold

Portnall Road, London, W9

Ground Floor

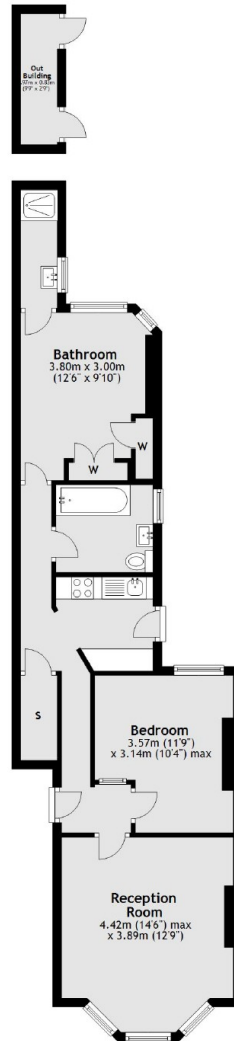

Total area: approx. 61.1 sq. metres (657.7 sq. feet)

Contact

To arrange a viewing call our office on the number below or visit our website.



Energy Rating: C. We aim to make our particulars both accurate and reliable. However they are not guaranteed; nor do they form part of an offer or contract. If you require clarification on any points then please contact us, especially if you're traveling some distance to view. Please note that appliances and heating systems have not been tested and therefore no warranties can be given as to their good working order.