



Britton Street, EC1M

£810 Per week

A large apartment in a popular development with 24 hour concierge and lift access. The property has been recently refurbished to an excellent standard and it is available furnished.

City Pavilion is located on the corner of Britton Street and Benjamin Street, less than 200 yards from Farringdon Underground and main line station.

Features

- Parking (Sep Negotiation)
- 24 Hour Concierge
- Floor To Ceiling Windows
- Fourth Floor With Lift
- Modern Bathrooms
- Wood Style Flooring

Britton Street,
London, EC1M

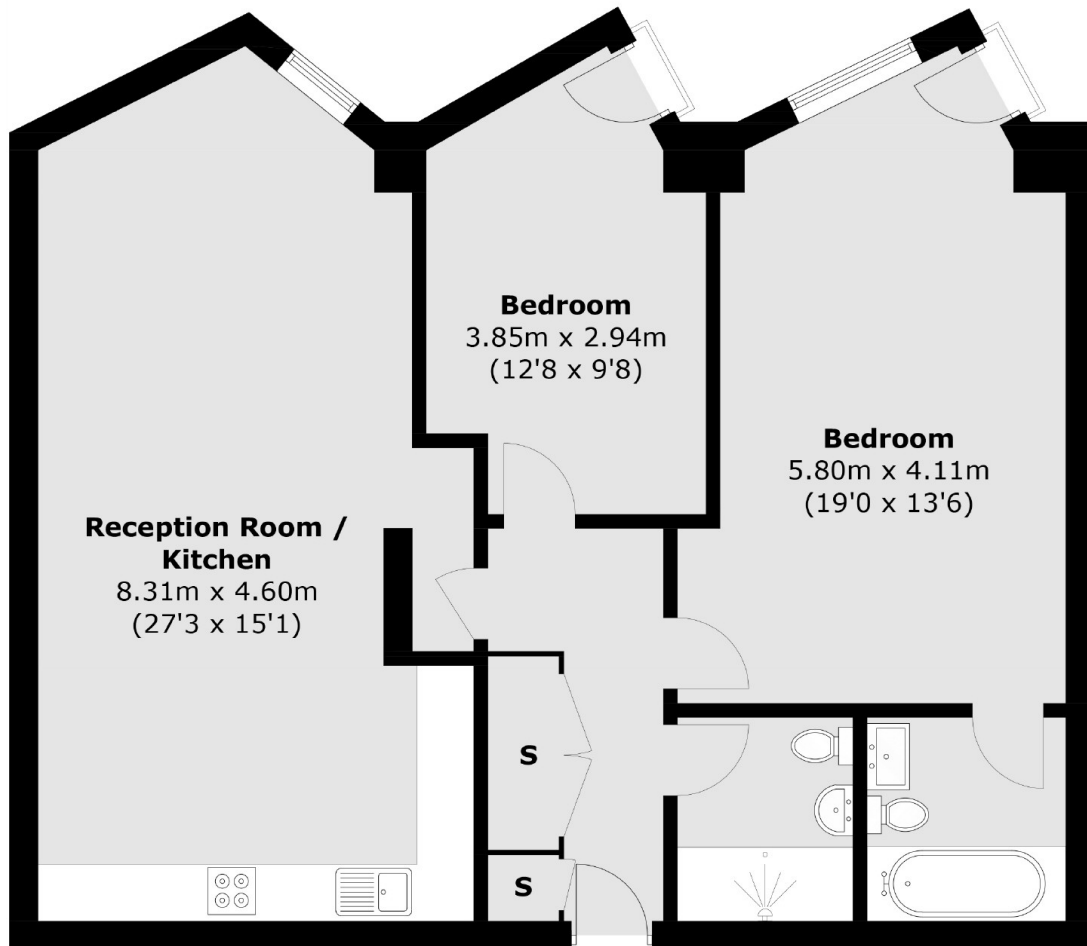

Fourth Floor

Total area (approx.): 92.8 sq. m (998.8 sq. ft)