



Hillrise, KT12  
£620,000

Waterview



A beautifully presented, spacious three bed apartment set within landscaped gardens overlooking The Thames at Walton.

Hillrise is located off Manor Road, close to the centre of Walton-on-Thames.







Accommodation is made up of a large double reception room with dining area, triple aspect and river facing balcony. There is a modern integrated kitchen.

The principal bedroom has built-in wardrobes and en-suite shower room. There are two further double bedrooms and a family bathroom. The apartment is set within pretty, landscaped gardens overlooking The Thames within this gated development with a 28' double length garage.

### Features

Spacious Apartment  
Three Bedrooms  
Two Bathrooms  
River Views  
No Chain  
Large Garage



# Hillrise, Walton-on-Thames, KT12

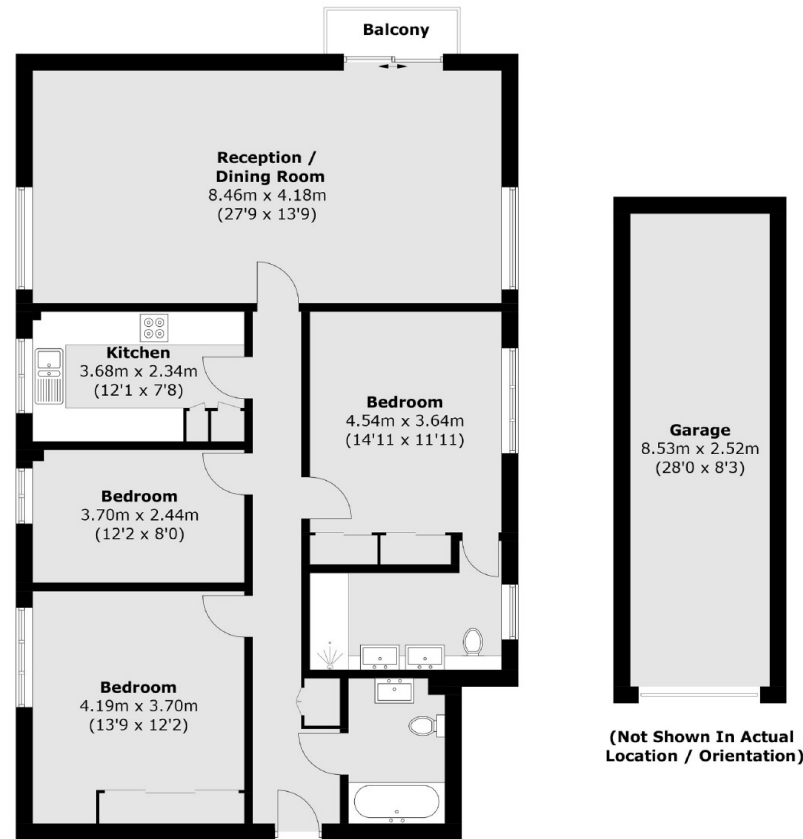

## Second Floor

Total area (approx.): 112.4 sq. m (1,210.0 sq. ft)  
Garage: 21.5 sq. m (231.4 sq. ft)

## Contact

To arrange a viewing call our office on the number below or visit our website.



Regulated  
Estate Agent  
and Letting Agent

Energy Rating: D. We aim to make our particulars both accurate and reliable. However they are not guaranteed; nor do they form part of an offer or contract. If you require clarification on any points then please contact us, especially if you're traveling some distance to view. Please note that appliances and heating systems have not been tested and therefore no warranties can be given as to their good working order.



