



Thames Eyot, TW1

£325,000

A wonderful one bedroom apartment on the ground floor of this former hotel with terrace and extensive riverside gardens, resident's parking and no onward chain.

Thames Eyot is located in the heart of Twickenham, with a huge range of shops, pubs and restaurants nearby.

Features

- Riverside Apartment
- Beautiful Building
- Extensive Gardens
- No Chain
- Resident's Parking
- River Views

Thames Eyot, Twickenham, TW1

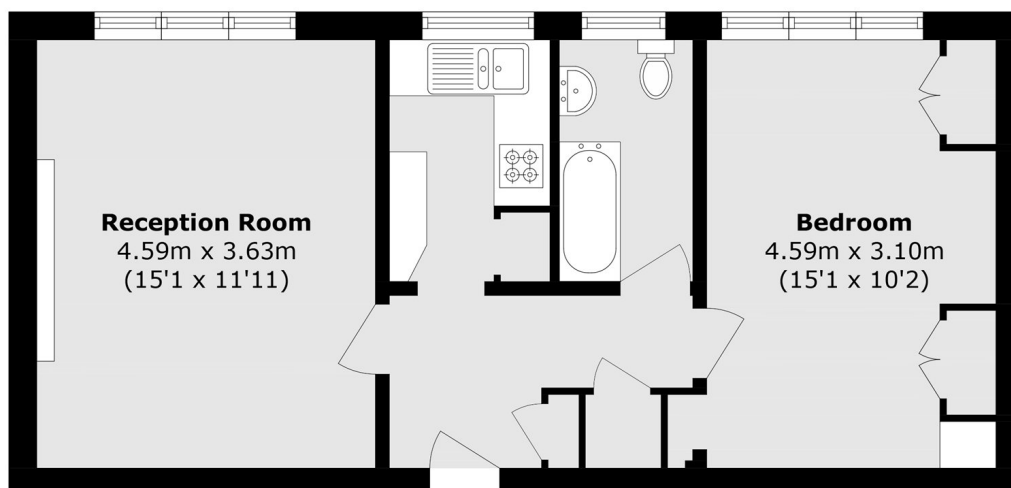

Total area (approx.): 47.2 sq. m (508.1 sq. ft)

Contact

To arrange a viewing call our office on the number below or visit our website.



Energy Rating: C. We aim to make our particulars both accurate and reliable. However they are not guaranteed; nor do they form part of an offer or contract. If you require clarification on any points then please contact us, especially if you're traveling some distance to view. Please note that appliances and heating systems have not been tested and therefore no warranties can be given as to their good working order.