



The Avenue, TW16

£1,250,000

A spacious five bedroom detached house with a garage, off street parking and a large rear garden. This property offers a flexible layout and is well presented throughout, ready for you to move straight in to.

The Avenue, one of Lower Sunbury's most prestigious roads, located in the heart of the village the position is hard to beat! Sunbury Park, village shops, the River Thames, riverside pubs & restaurants are all on your doorstep.

Features

Detached
Five Bedrooms
Three Reception Rooms
Two Bathrooms
Off Street parking
Garage



The Avenue, Sunbury-On-Thames, TW16

On the ground floor there is a welcoming entrance hallway, three reception rooms, a downstairs W.C. and a kitchen breakfast room which leads out onto the patio section of the rear garden.

On the first floor there is a master bedroom with an en-suite shower room, three additional double bedrooms, a fifth bedroom which is currently used as a home office and a family bathroom. To the rear of the property there is a large garden with two patio areas and an expansive lawn.

At the front of the property there is off street parking for four cars and a garage. Homes like this rarely come on to the market, give us a call straight away to arrange a viewing of this beautiful forever family home.





The Avenue, Sunbury-On-Thames, TW16

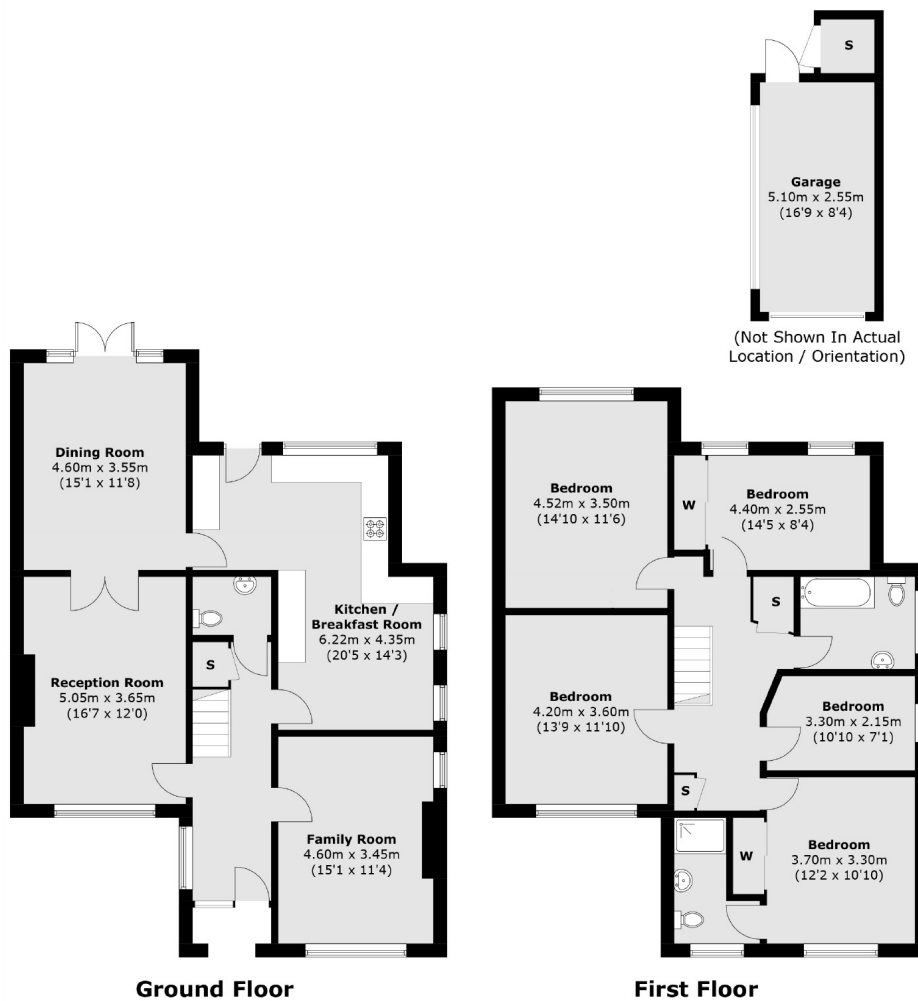

Total area (approx.): 179.0 sq. m (1,926.6 sq. ft)
Garage / Store: 14.7 sq. m (158.2 sq. ft)

Contact

To arrange a viewing call our office on the number below or visit our website.



Energy Rating: D. We aim to make our particulars both accurate and reliable. However they are not guaranteed; nor do they form part of an offer or contract. If you require clarification on any points then please contact us, especially if you're traveling some distance to view. Please note that appliances and heating systems have not been tested and therefore no warranties can be given as to their good working order.