



St. Luke's Avenue, SW4

£430,000

A stylish first floor period conversion presented in immaculate order throughout, comprising an open plan reception room with a modern kitchen, a double bedroom and a bathroom.

St Lukes Avenue is located just off Clapham High Street, close to Clapham Old Town and Clapham Common with vibrant and bustling cafes, restaurants and bars located just around the corner, and only 0.2 miles from Clapham North and Clapham High (Northern Line).

Features

- Period Conversion
- First Floor
- Open Plan Reception
- Modern Kitchen
- Double Bedroom
- Long Lease

St. Luke's Avenue, London, SW4

First Floor

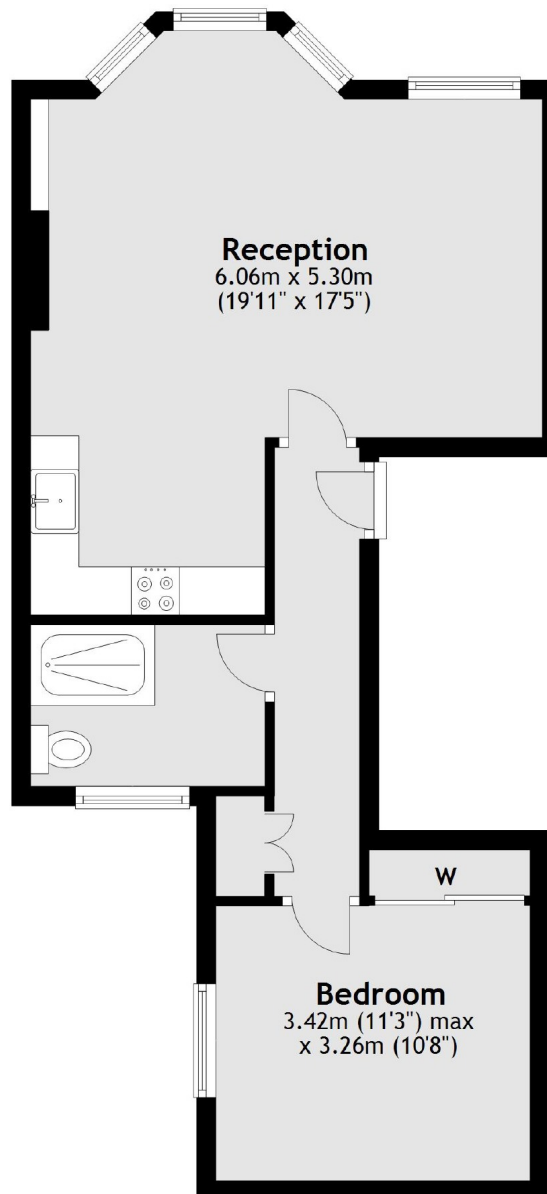

Total area: approx. 44.7 sq. metres (480.7 sq. feet)

Contact

To arrange a viewing call our office on the number below or visit our website.



Energy Rating: D. We aim to make our particulars both accurate and reliable. However they are not guaranteed; nor do they form part of an offer or contract. If you require clarification on any points then please contact us, especially if you're traveling some distance to view. Please note that appliances and heating systems have not been tested and therefore no warranties can be given as to their good working order.