

Malthouse Road, SW11

£658 Per week

A well-presented one bedroom apartment within this luxurious Nine Elms development presents a spacious open plan reception room, a high specification kitchen, wooden flooring throughout, a modern bathroom and a private balcony. The property further benefits from a resident's gym, communal roof terrace and media lounge.

Lexington Gardens is perfectly located, providing close transport links including Nine Elms, Battersea Power Station & Vauxhall underground station. The property is also moments away from the amenities of Embassy Gardens and Battersea Power Station; shops, restaurants and cafés.

Features

- One Double Bedroom
- Modern Bathroom
- High Specification
- Residents Gym
- 24/7 Concierge
- Prime Location

Malthouse Road,
London, SW11

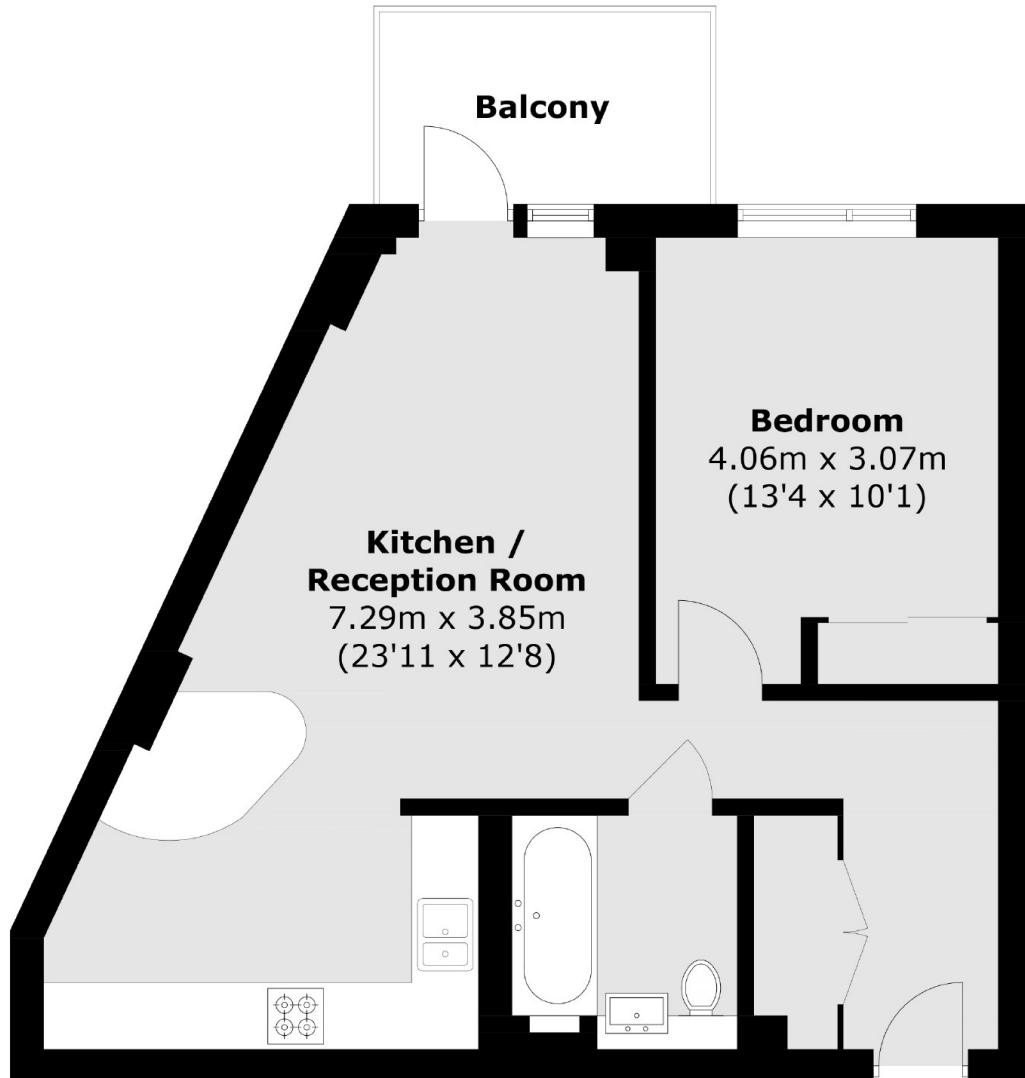

Total area (approx.): 53.4 sq. m (574.8 sq. ft)
Balcony area: 5.1 sq. m (54.9 sq. ft)

Dexters

Vauxhall
377-379 Kennington Lane
London
SE11 5QY
Lettings
020 7793 8111

Energy Rating: B. We aim to make our particulars both accurate and reliable. However they are not guaranteed; nor do they form part of an offer or contract. If you require clarification on any points then please contact us, especially if you're traveling some distance to view. Please note that appliances and heating systems have not been tested and therefore no warranties can be given as to their good working order.

 **RICS** | Regulated
Estate Agent
and Letting Agent

dexters.co.uk