



## Hertford Road, N1

£695 Per week

Three double bedroom flat on the fifth floor of this modern riverside development. With wood floors throughout, private balcony accessed from all rooms and large living room this is the perfect property for professional sharers and families.

Close to the many amenities of Hackney Road and Kingsland Road, and a short walk to the shops, bars and restaurants of Shoreditch and The Regents Canal. Haggerston Station just a 200 meters away.

### Features

Modern Canalside Development  
Three Double Bedrooms  
5th Floor  
Private Balcony  
Wood Floors  
Two Bathrooms

Hertford Road,  
London, N1

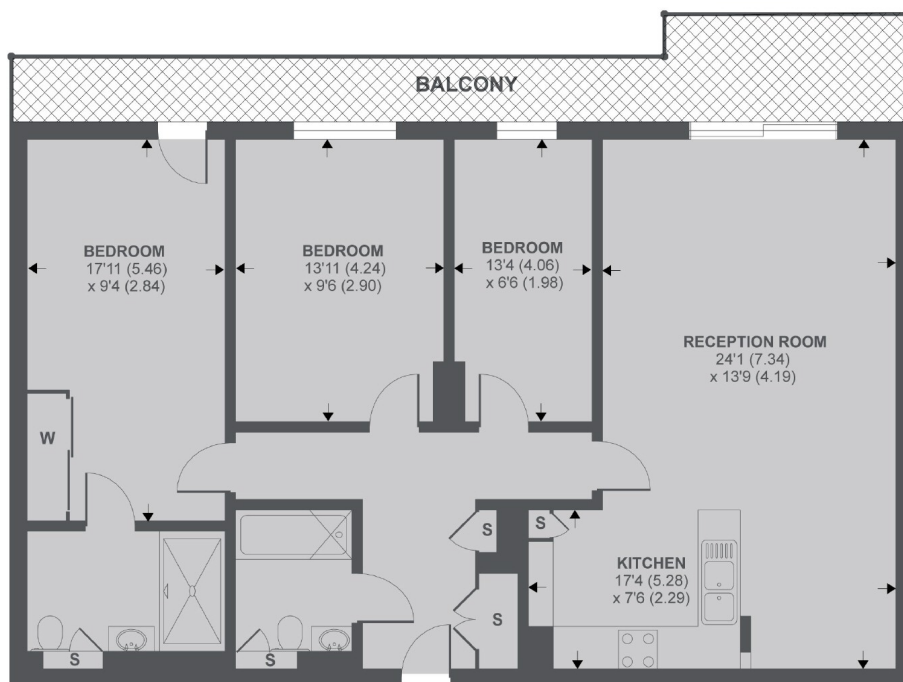

5th Floor

## Reliance Wharf N1

APPROX FLOOR AREA 984 SQ.FT 91.4 SQ.M

Copyright nichecom.co.uk 2019 REF : 459556

### Contact

To arrange a viewing call our office on the number below or visit our website.



Energy Rating: C. We aim to make our particulars both accurate and reliable. However they are not guaranteed; nor do they form part of an offer or contract. If you require clarification on any points then please contact us, especially if you're traveling some distance to view. Please note that appliances and heating systems have not been tested and therefore no warranties can be given as to their good working order.