

## Friary Road, W3

£999,950

A 1930s built house with four bedrooms and an additional loft room. The ground floor layout is ideal for a growing family with two reception rooms, a dining area and a bedroom/ study room with an en suite shower room.

Less than 250 metres from Acton Main Line station (forthcoming Elizabeth line), half a mile from North Acton tube (Central line) and a quarter of a mile from Acton Central (Overground).

### Features

- Semi-Detached
- Refurbished
- Two Bathrooms
- Potential To Extend (STPP)
- No Onward Chain
- Driveway Parking

## Friary Road, London, W3

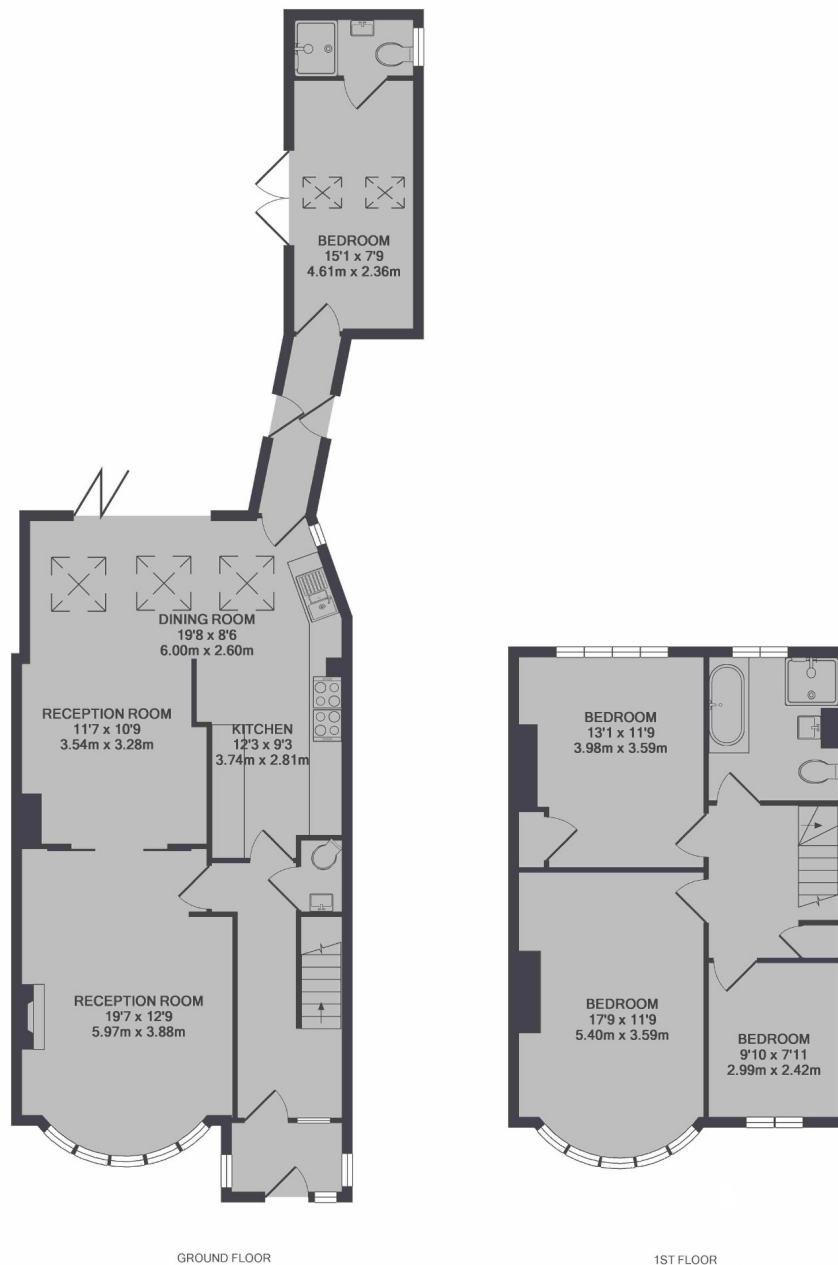

TOTAL APPROX. FLOOR AREA 1565 SQ.FT. (145.4 SQ.M.)

### Contact

To arrange a viewing call our office on the number below or visit our website.



Energy Rating: D. We aim to make our particulars both accurate and reliable. However they are not guaranteed; nor do they form part of an offer or contract. If you require clarification on any points then please contact us, especially if you're traveling some distance to view. Please note that appliances and heating systems have not been tested and therefore no warranties can be given as to their good working order.