



## Gunnersbury Lane, W3

£750,000

An end of terrace modern home arranged over three floors with just under 1,300 sq.ft of living space. The house has a high quality contemporary finish throughout including underfloor heating on the ground floor.

Under a quarter of a mile from Acton Town tube station (District and Piccadilly lines) and just over three quarters of a mile from Acton Central station (Overground).

### Features

- Three Bedrooms
- Two Bathrooms
- South-Facing Garden
- Allocated Parking Space
- Underfloor Heating
- Separate Kitchen

## Gunnersbury Lane, London, W3

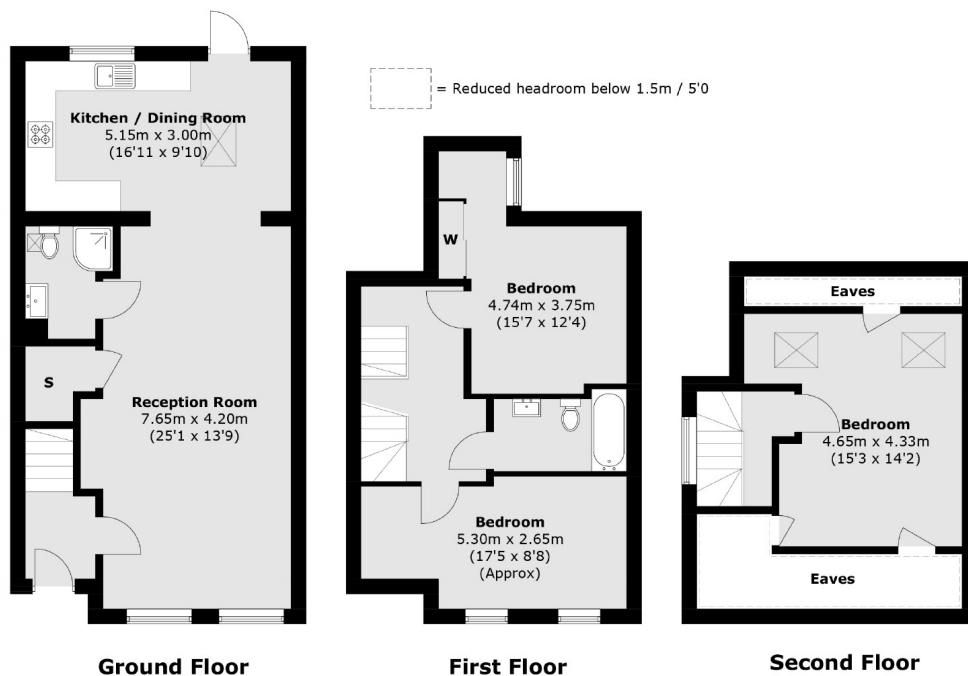

Total area (approx.): 119.0 sq. m (1280.8 sq. ft)  
(Excluding Eaves)

### Contact

To arrange a viewing call our office on the number below or visit our website.



Energy Rating: B. We aim to make our particulars both accurate and reliable. However they are not guaranteed; nor do they form part of an offer or contract. If you require clarification on any points then please contact us, especially if you're traveling some distance to view. Please note that appliances and heating systems have not been tested and therefore no warranties can be given as to their good working order.