



Whitehall Gardens, W3

£1,100,000

A semi-detached Edwardian period home arranged over three floors with five bedrooms and just under 2,000 sq.ft of internal living space. The house has a south-facing garden and roof terrace.

Under half a mile from Ealing Common and Acton Town tube stations (District and Piccadilly lines) and under a mile from Acton Main Line station (forthcoming Elizabeth line).

Features

Edwardian House
Semi-Detached
Five Bedrooms
Separate Kitchen
Two Reception Rooms
Two Bathrooms

Whitehall Gardens, London, W3

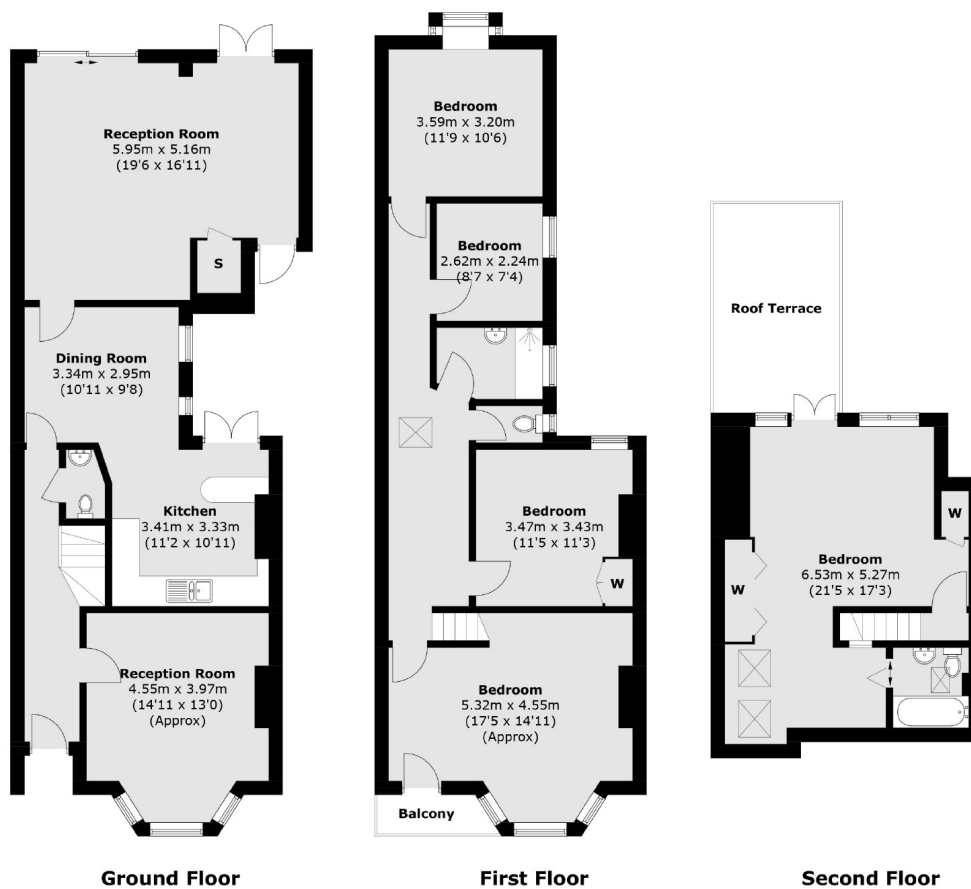

Total area (approx.): 181.7 sq. m (1,955.7 sq. ft)
Balcony / Roof Terrace area: 14.5 sq. m (156.0 sq. ft)

Contact

To arrange a viewing call our office on the number below or visit our website.



Energy Rating: D. We aim to make our particulars both accurate and reliable. However they are not guaranteed; nor do they form part of an offer or contract. If you require clarification on any points then please contact us, especially if you're traveling some distance to view. Please note that appliances and heating systems have not been tested and therefore no warranties can be given as to their good working order.