



Silver Crescent, W4

£1,175,000

Dexters



Silver Crescent, London, W4

A well-presented four bedroom semi-detached house. This property offers double glazing, bamboo flooring, bespoke joinery in every room, a west-facing garden and scope to extend STP.

The ground floor has a welcoming hallway that leads into a well-presented reception room with stunning contemporary stained glass interior doors. Towards the back of the property there is a kitchen diner with further expansion options subject to planning.

The first floor houses three good-sized bedrooms, all of which have built-in wardrobes, and a family bathroom.

The second floor has a further double bedroom with an en suite and plenty of eaves for storage and further cupboards. The property also has the benefit of a conservatory currently used as a workshop.

Silver Crescent is located just off of Chiswick High Road and its associated restaurants, shops and bars. It is also in close proximity to Gunnersbury tube station and Kew Bridge mainline station.

Features

- Four Bedrooms
- Semi-Detached
- Close To Transport
- Double glazing Throughout
- West-Facing Garden
- Scope To Extend STP







Silver Crescent, London, W4

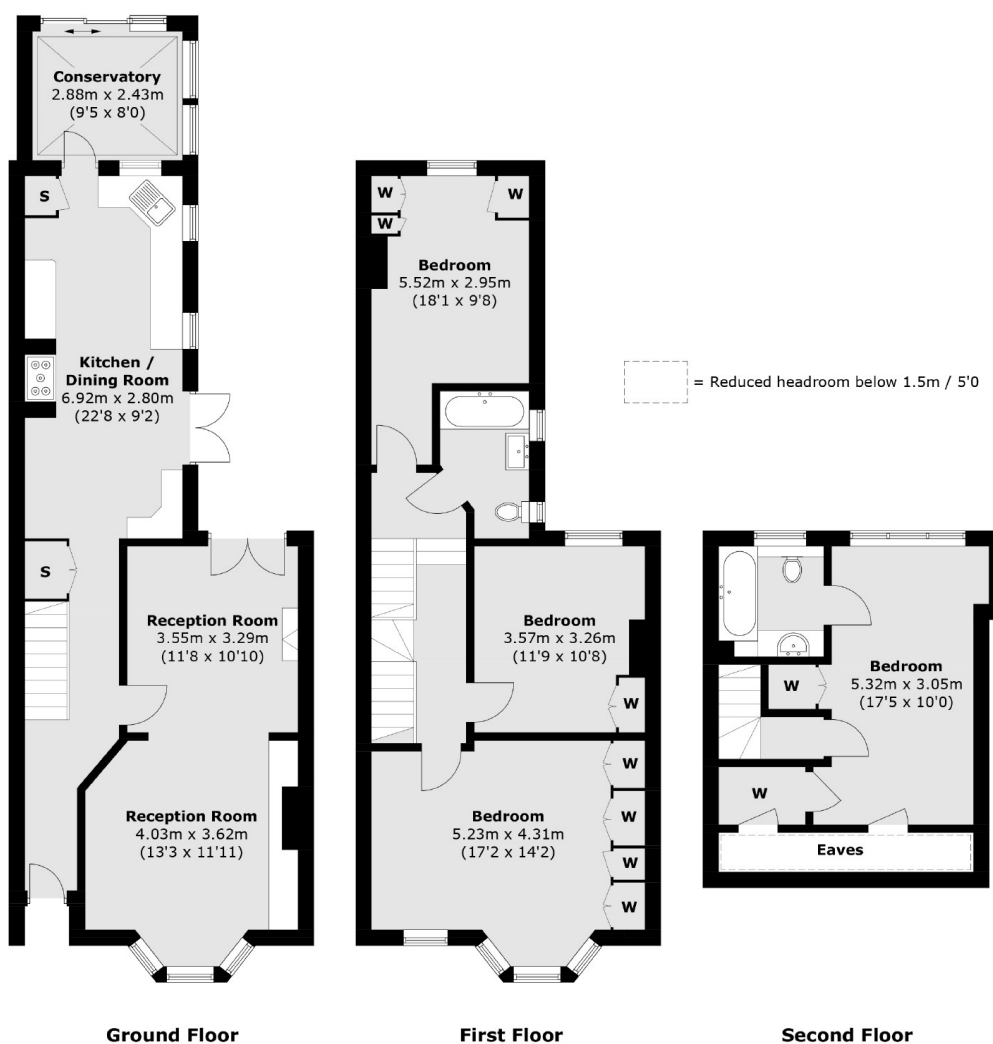

Total area (approx.): 154.2 sq. m (1659.6 sq. ft)
(Excluding Eaves)

Dexters

Chiswick
388 Chiswick High Road,
Chiswick, London, W4 5TF

Sales
020 8995 4321

Energy Rating: E. We aim to make our particulars both accurate and reliable. However they are not guaranteed; nor do they form part of an offer or contract. If you require clarification on any points then please contact us, especially if you're traveling some distance to view. Please note that appliances and heating systems have not been tested and therefore no warranties can be given as to their good working order.

RICS | Regulated
Estate Agent
and Letting Agent

[dexters.co.uk](https://www.dexters.co.uk)