



Cricklade Avenue, SW2
£1,100,000

Dexters



Cricklade Avenue, SW2

A 'Bookend' of terrace Victorian style new new build family home. There are four bedrooms, three bathrooms and two reception rooms. On the ground floor, you have a large entrance hall, downstairs W.C, kitchen/breakfast room with hand painted kitchen and a separate family room with a media wall. EPC Rating B.

There are a significant number of energy-saving and ecological additions, including solar panels on the roof, reducing your electricity bill as well as Grey water tanks installed in the garden that takes the rain water from the roofs and patio and can be used to water the outdoor plants.

The house has fibre optic broadband connection to the street, as well as a pre-installed TV aerial, supplying Freeview TV to all 5 points in the house (4 bedrooms and the lounge). Additionally, the house is fitted with an intruder alarm system throughout.

Cricklade Avenue is located just off Streatham Hill and forms part of the ABCD roads. Streatham Hill mainline station is a short walk away as well as lots of local restaurants and amenities. Brixton is also easily accessible with regular buses going to and from the Station.

Features

- Popular ABCD Roads
- Four Bedrooms
- Three Bathrooms
- Hand Painted Bespoke Kitchen
- Siemens Appliances
- Fully Landscaped Garden







Cricklade Avenue, Streatham Hill, SW2

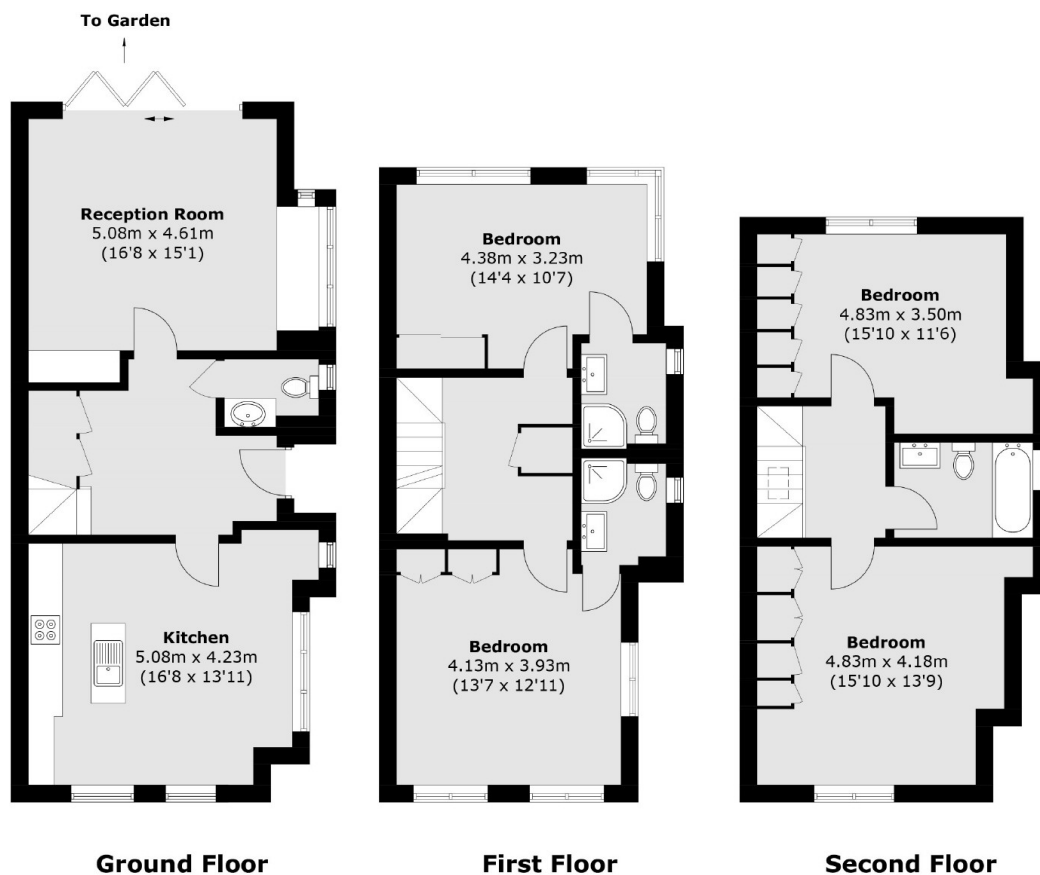

Total area (approx.): 143.8 sq. m (1547.9 sq. ft)