



Clapham, SW4

£795,000

A spacious three bedroom home with the luxury of a private garden and off street parking. The property has been finished to an uncompromising standard featuring a number of well considered interior details and renewable energy sources.

Located within a peaceful residential area the development is walking distance from leafy Clapham and Tooting Commons. Situated within zone 2 it is a short journey in to central London whilst retail and leisure facilities are close by.

Features

- Three Bedrooms
- Private Garden
- 12 Year NHBC Warranty
- Off Street Parking
- Integrated Appliances
- Renewable Energy Source

Bourke Close, London, SW4

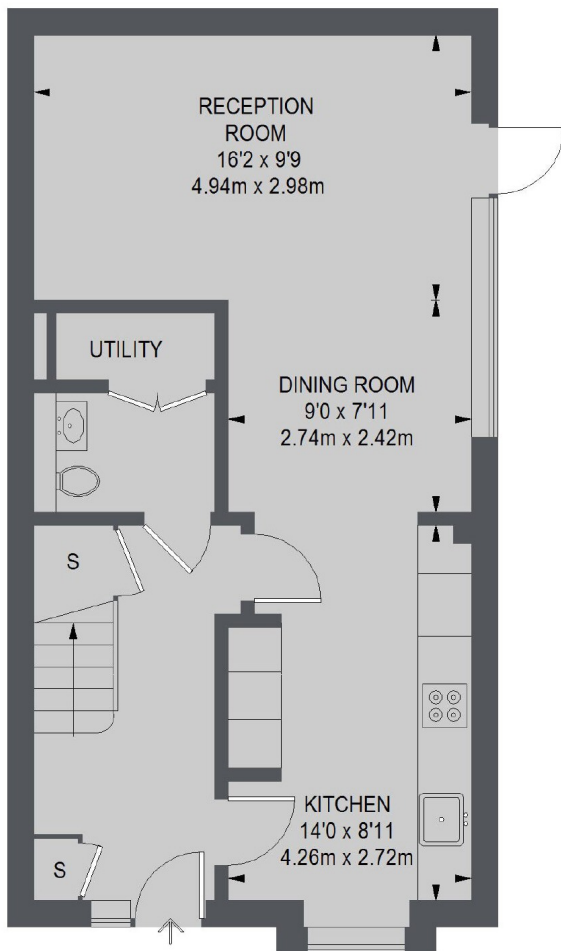

GROUND FLOOR

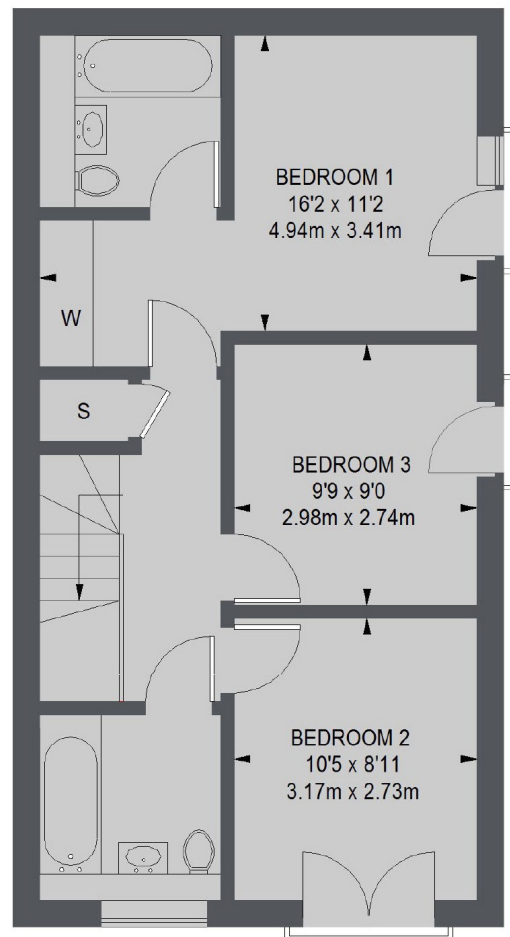

FIRST FLOOR

TOTAL APPROX. FLOOR AREA 1056 SQ. FT. (98.06 SQ. M.)

Contact

To arrange a viewing call our office on the number below or visit our website.



Energy Rating: D. We aim to make our particulars both accurate and reliable. However they are not guaranteed; nor do they form part of an offer or contract. If you require clarification on any points then please contact us, especially if you're traveling some distance to view. Please note that appliances and heating systems have not been tested and therefore no warranties can be given as to their good working order.