



## Willoughby Road, TW1

£2,695 Per calendar month

A beautifully presented two bedroom apartment located on the ground floor of this prestigious riverside development. The property features a private courtyard, allocated parking, and a modern finish throughout. Set within a secure gated community, residents enjoy access to stunning landscaped communal gardens overlooking the River Thames, offering a serene and picturesque setting.

Willoughby Road is a quiet cul-de-sac leading down to the banks of the River Thames and Richmond Bridge. Within 0.8 miles of Richmond town centre and the train station.

### Features

- Two Bedrooms
- Riverside Location
- Private Patio Garden
- Modern Bathroom
- Gated Development
- Allocated Parking

Willoughby Road,  
Twickenham, TW1

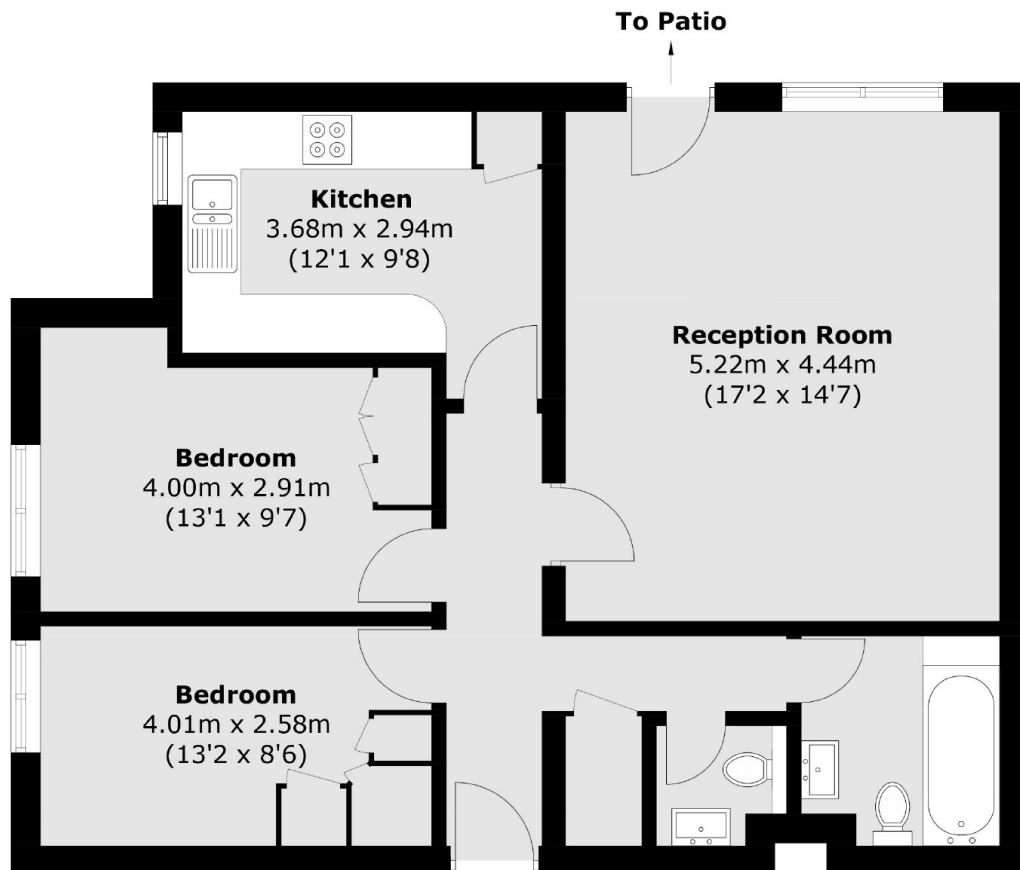

Total area (approx.): 70.5 sq. m (758.8 sq. ft)

**Dexters**

St Margarets  
1 Chertsey Road  
St Margarets  
TW1 1LR  
Lettings  
020 8744 9700

Energy Rating: C. We aim to make our particulars both accurate and reliable. However they are not guaranteed; nor do they form part of an offer or contract. If you require clarification on any points then please contact us, especially if you're traveling some distance to view. Please note that appliances and heating systems have not been tested and therefore no warranties can be given as to their good working order.

 **RICS** | Regulated  
Estate Agent  
and Letting Agent

[dexters.co.uk](http://dexters.co.uk)