



## Swan Street, TW7

£1,750 Per calendar month

A larger than average, one bedroom flat in this riverside development is now ready to view. There is underfloor heating, ample storage and for those who love to people watch, a private balcony looking onto the communal gardens.

Lion Wharf sits on the river with tow path walks to Richmond and St Margarets village. South Streets popular cafés and restaurants are 500 feet away. Richmond's fast over ground rail service with its links into London Waterloo and District Line is within 1.4 miles.

### Features

- Riverside Development
- Large Open-Plan Living
- One Double Bedroom
- Luxury Bathroom
- Private Balcony
- Allocated Parking

# Swan Street, Old Isleworth, TW7

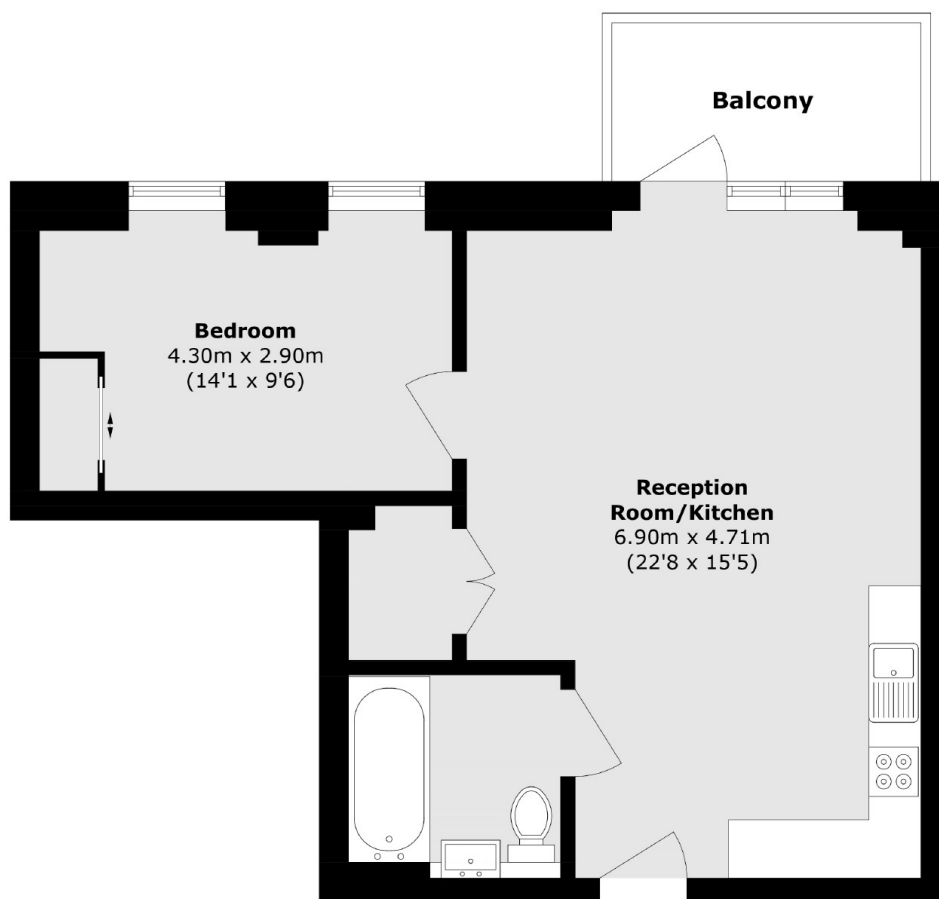

Total area (approx.): 50.0 sq. m (538.2 sq. ft)

Balcony area (approx.): 5.2 sq. m (55.9 sq. ft)