

Melliss Avenue, TW9

£420,000

A beautifully presented one double bedroom flat situated on the second floor of this well-maintained building within the popular Kew Riverside development. The apartment has a private balcony and comes with an allocated parking space located in the underground car park.

Lime House is a sought after residential development set within communal landscaped gardens. Located within easy reach of the Thames Path, Kew Retail Park, Kew Gardens Station providing District Line and Overground services and the local village shopping amenities.

Features

- One Double Bedroom
- Modern Kitchen & Bathroom
- Private Balcony
- Private Parking Space
- Concierge And Health Club
- No Onward Chain

Melliss Avenue,
Kew, TW9

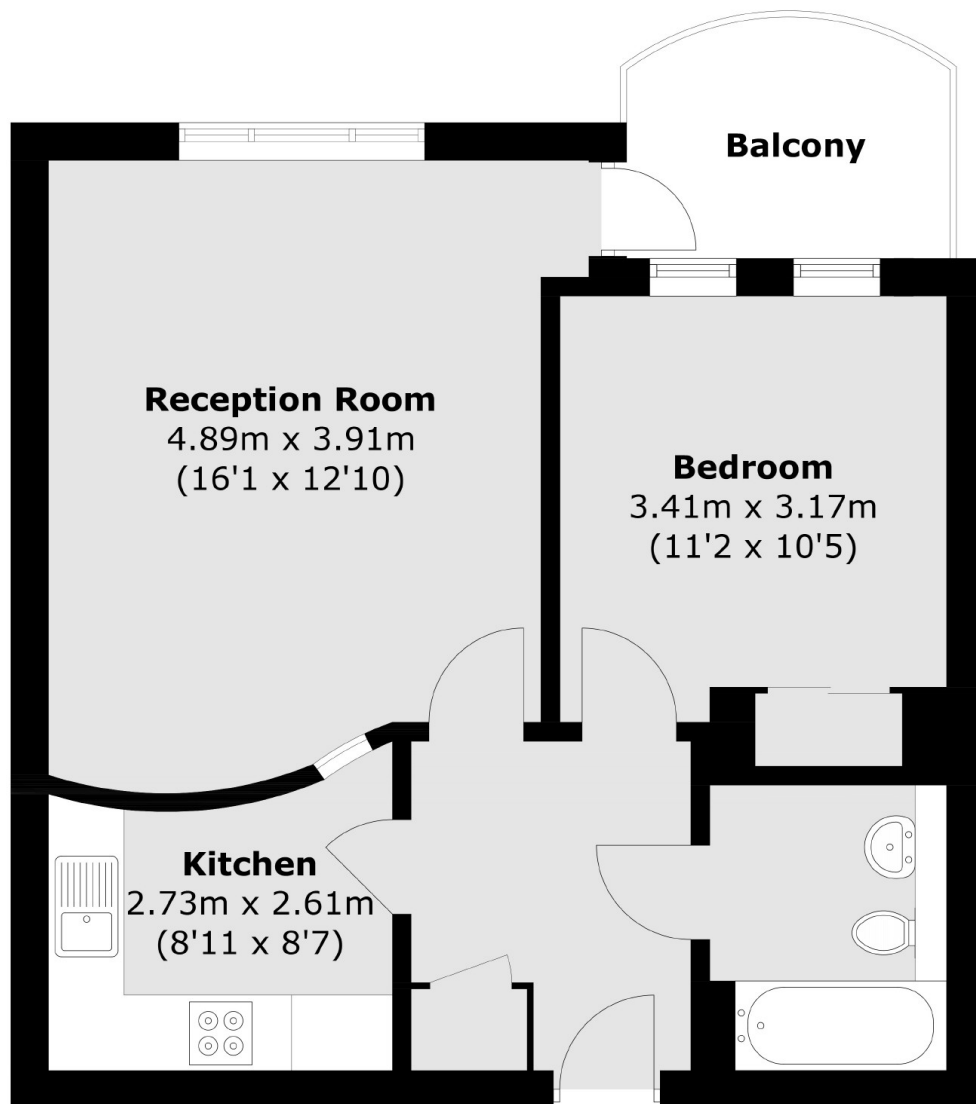

Total area (approx.) :48.7sq. m (524.2 sq. ft)
Balcony : 4.6 sq. m (49.5 sq. ft)

Dexters

Richmond
1 Sheen Road
Richmond
TW9 1AD
Sales
020 8288 9988

Energy Rating: Tbc. We aim to make our particulars both accurate and reliable. However they are not guaranteed; nor do they form part of an offer or contract. If you require clarification on any points then please contact us, especially if you're traveling some distance to view. Please note that appliances and heating systems have not been tested and therefore no warranties can be given as to their good working order.

 **RICS** | Regulated
Estate Agent
and Letting Agent

dexters.co.uk