



Penrhyn Road, KT1

£790,000

Named after the finely cut masonry blocks that define the building's facade, 'Ashlar' showcases the precision and artistry of stonework laid in perfect symmetry, creating a smooth, refined surface. This superb two bedroom apartment is situated on the third floor has been designed with high specification throughout, including engineered wood floorings and contemporary ironmongery in a matt bronze finish.

County Hall Kingston is within walking distance of Kingston Town Centre and Kingston railway station. With regular services to London Waterloo, and opportunities to connect to the London Underground, accessing the city is swift and straightforward.

Features

- New Build
- Build Warranty
- High Specification
- One, Two and Three Bedroom Apartments
- Close To River Thames
- Close To Shops
- Close To Train

Penrhyn Road, Kingston Upon Thames, KT1

Apartments 303

2 BEDROOM | BUILDING ASHLAR HOUSE

THIRD FLOOR

APARTMENT
303

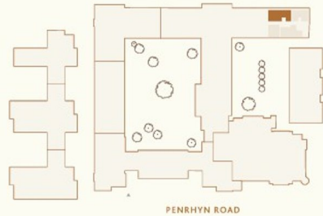

ROOM DIMENSIONS

LIVING/ KITCHEN/ DINING ROOM
5.08M X 5.72M | 16'8" X 18'9"

PRINCIPAL BEDROOM
2.59M X 3.82M | 9'10" X 12'7"

BEDROOM 2
3.03M X 2.45M | 9'11" X 8'1"

TOTAL INTERNAL AREA
66 M² | 706 FT²



KEY

W - WARDROBE 2M -----

W - OPTIONAL WARDROBE 1.5M -----

W/D - WASHER DRYER

Total floor area may vary slightly to the figure that is listed. Wardrobes are included in the principal bedroom only, all other furniture is indicative and not supplied. Dotted lines indicate areas where ceiling heights may vary.