

Felstead Gardens, E14

£400,000

A two double-bedroom home located in the sought-after riverside development of Felstead Gardens. The property includes 675 square feet of ample living space, allocated parking, a Juliette balcony from the master bedroom, and no onward chain.

Felstead Gardens is just a few minutes' walk from the Island Gardens DLR, providing access to Canary Wharf, Central London, and many other locations. This property also benefits from being a short walk away from local shops, restaurants, and bars. Additionally, the Greenwich foot tunnel is nearby, offering access to Greenwich.

Features

- Two Double Bedrooms
- Residents Parking
- Riverside Development
- 675 Square Feet
- River Views
- No Onward chain

Felstead Gardens, London, E14

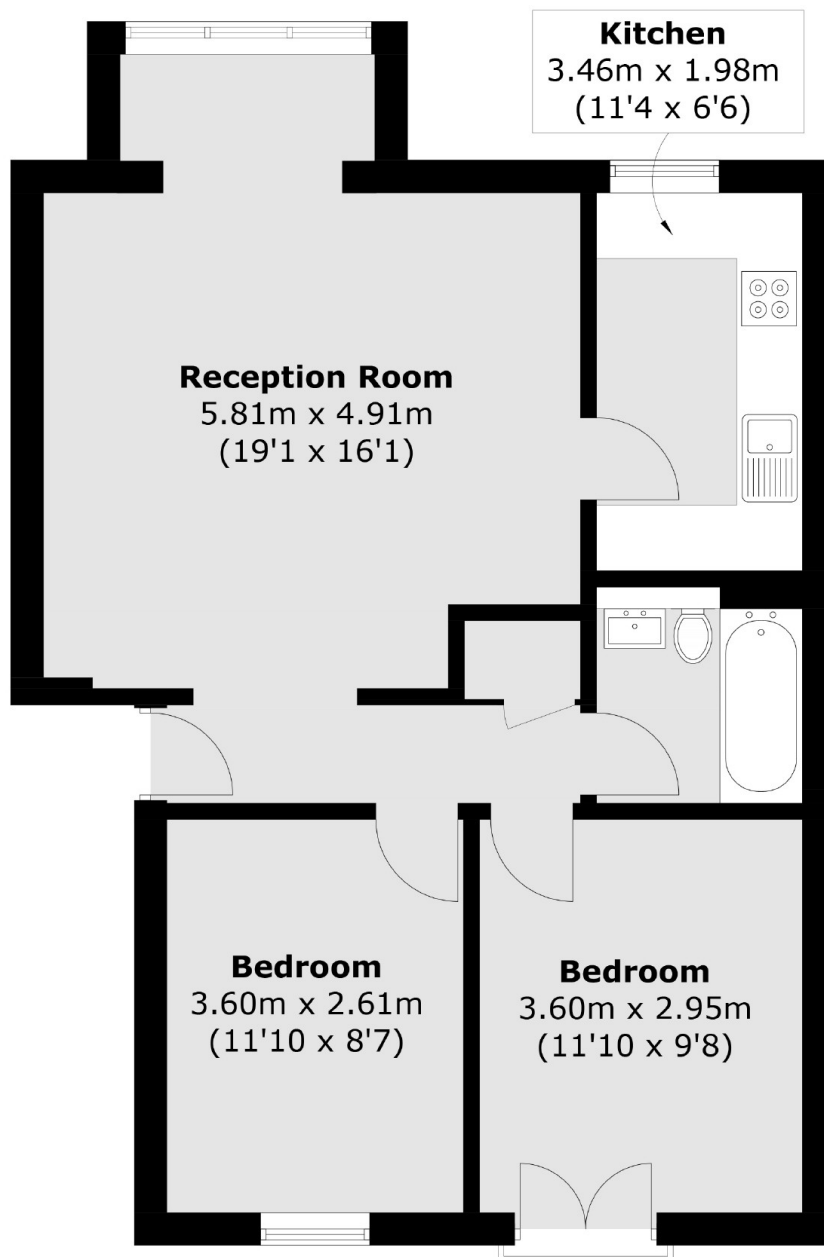

Total area (approx.): 62.7 sq. m (674.9 sq. ft)