



Millharbour, E14

£300,000

A spacious one-bedroom apartment located within the Millharbour development. The property features an open-plan reception room and benefits from easy access to the city.

Millharbour is located just 0.8 miles from Canary Wharf and 0.2 miles from South Quay DLR Station, both offering excellent transport links to the City.

Features

By Millharbour Dockside
579 Square Feet
Walking Distance To Canary Wharf
Dual Aspect Reception
Chain Free

Millharbour, London, E14

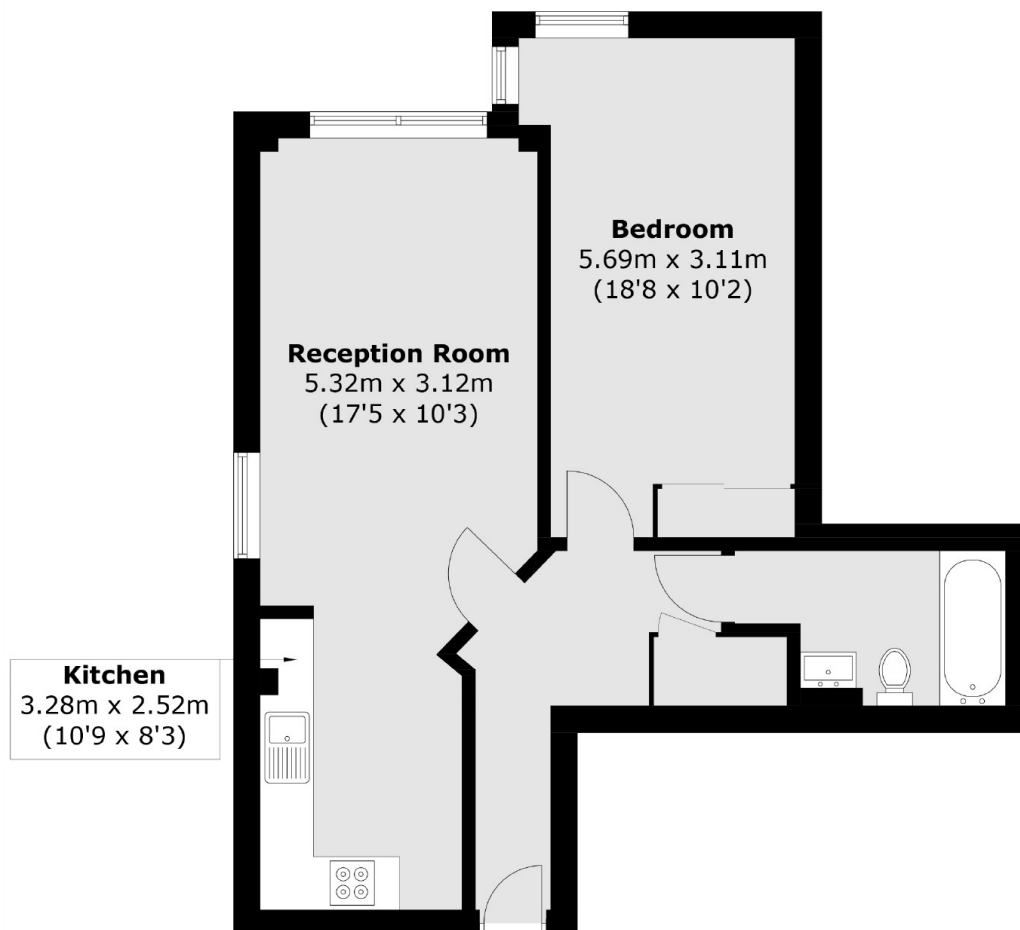

Total area (approx.): 53.8 sq. m (579.1 sq. ft)