



Wards Wharf Approach, E16

£370,000

Welcome to this bright and airy two-bedroom home, thoughtfully designed for modern living. The property features a spacious open-plan layout, a private balcony, and two stylish bathrooms, including an en-suite to the principal bedroom. Additional benefits include allocated parking, access to residents' facilities, and a dedicated concierge service all within a desirable, well-maintained development.

Ideally situated, Wards Wharf Approach is just 0.3 miles from Pontoon Dock DLR station, offering swift and convenient connections to Canary Wharf, the City, and other key destinations across London.

Features

- Two Double Bedrooms
- Chain Free
- Private Balcony
- Resident Gym And Sauna
- Concierge Services
- Allocated Parking

Wards Wharf Approach, London, E16

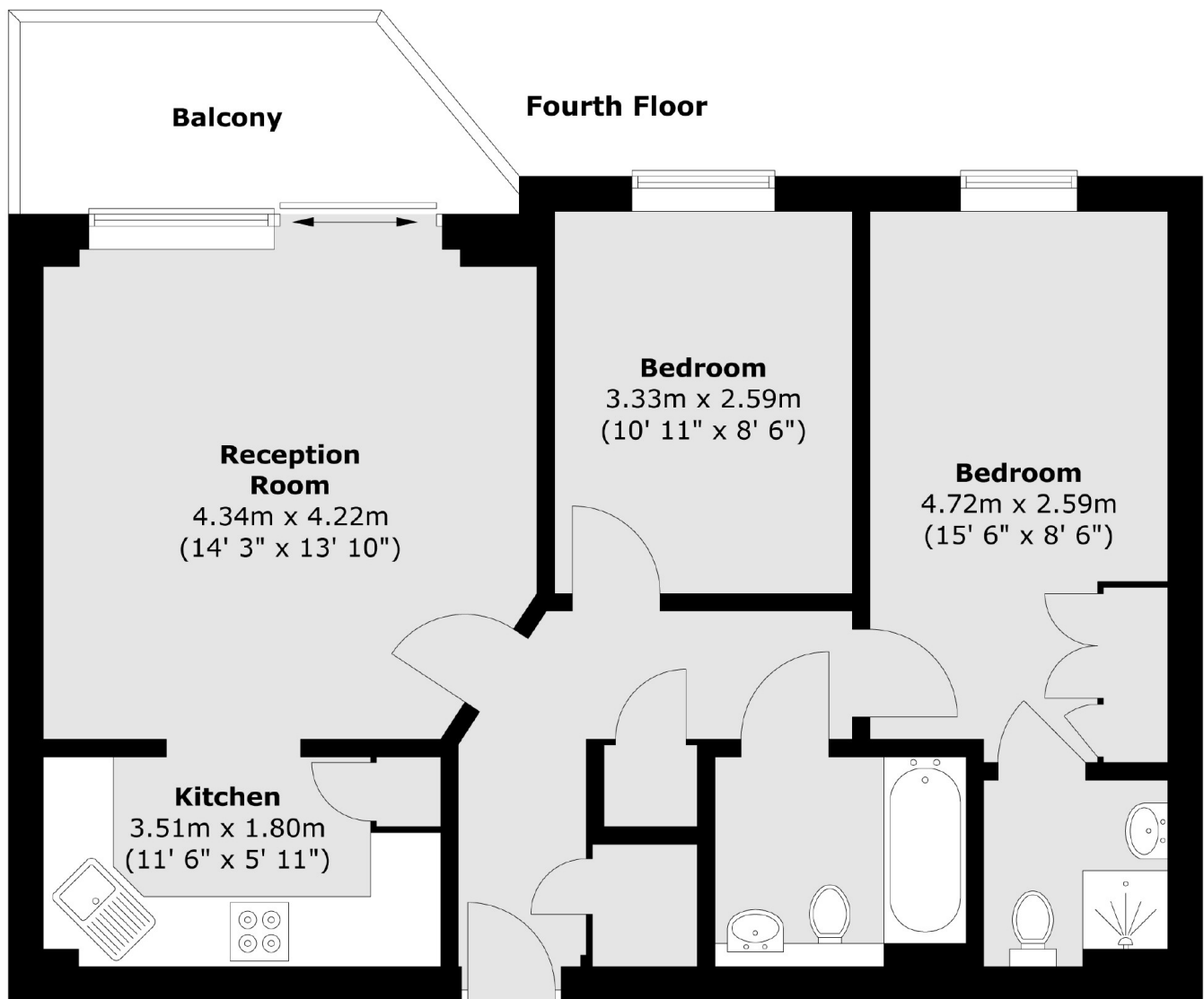

Total area (approx.) : 63.4 sq. m (682 sq. ft)
Total balcony area (approx.) : 6.3 sq. m (68 sq. ft)