



## Selsdon Way, E14

£325,000

Offered with no onward chain, this modern one-bedroom home features a bright open-plan reception and kitchen, two Juliette balconies, and a well-appointed bathroom. Residents benefit from concierge services, and the property is ideally located close to local amenities and excellent transport links.

Located close to Cross Harbour DLR, South Quay and within walking distance of Canary Wharf, a selection of shops, trendy bars, and premium restaurants, The Jubilee and Elizabeth lines for easy access to the City, West End, Heathrow and London City Airport

### Features

Second Floor  
Concierge Service  
Dockside Development  
Chain Free  
Two Juliette Balconies  
Modern Development

# Selsdon Way, London, E14

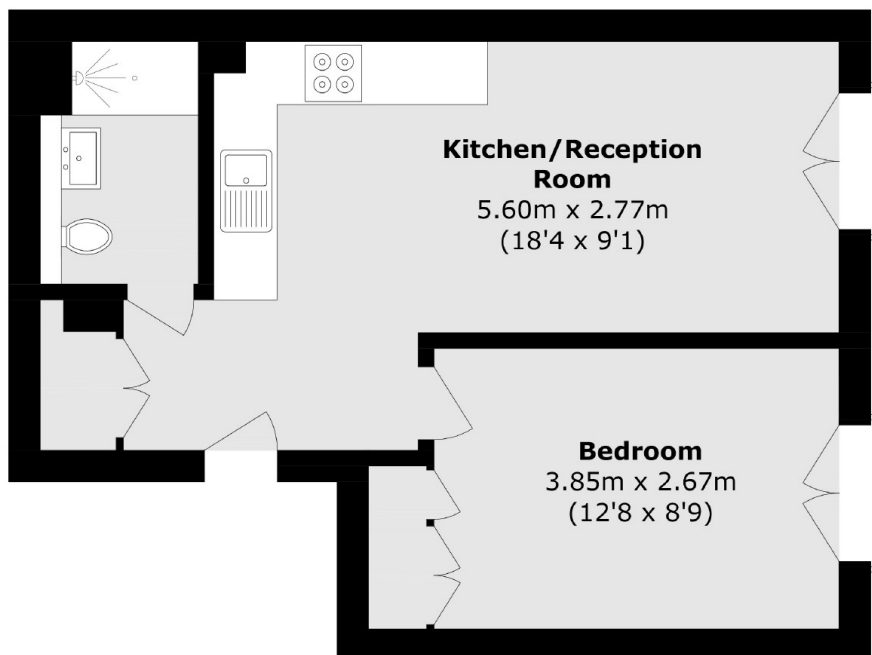

Total area (approx.): 37.1 sq. m (399.3 sq. ft)