



## Clyde Square, E14

£404 Per week

An impressive one bedroom apartment on the ground floor of this warehouse conversion. Split over two levels this apartment has floor to ceiling windows, wooden flooring and a gallery style bedroom.

Severn Court is moments from the shops, bars and restaurants of Canary Wharf including the renowned Browns all-day brasserie.

### Features

- One Bedroom
- Split Level
- Warehouse Conversion
- Interior Designed
- Private Entrance
- Recently Refurbished

# Clyde Square, London, E14

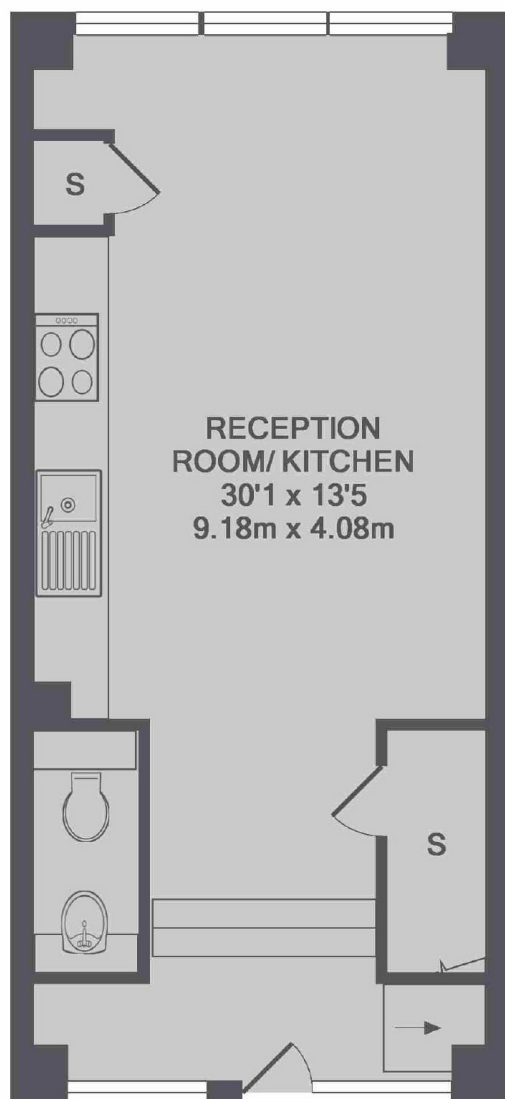

GROUND FLOOR



MEZZANINE FLOOR

TOTAL APPROX. FLOOR AREA 652 SQ.FT. (60.6 SQ.M.)