

South Quay Square, E14

£646 Per week

A large two bedroom apartment on the fifth floor of the iconic Discovery Dock. This property has river views, an open plan living space, private balcony and residents leisure facilities. Secure parking available.

Discovery Dock is perfectly located for easy reach to both South Quay DLR and Canary Wharf tube station.

Features

- Two Bedrooms
- Two Bathrooms
- Residents Gym
- Swimming Pool
- Balcony
- Secure Parking

South Quay Square, London, E14

5th Floor

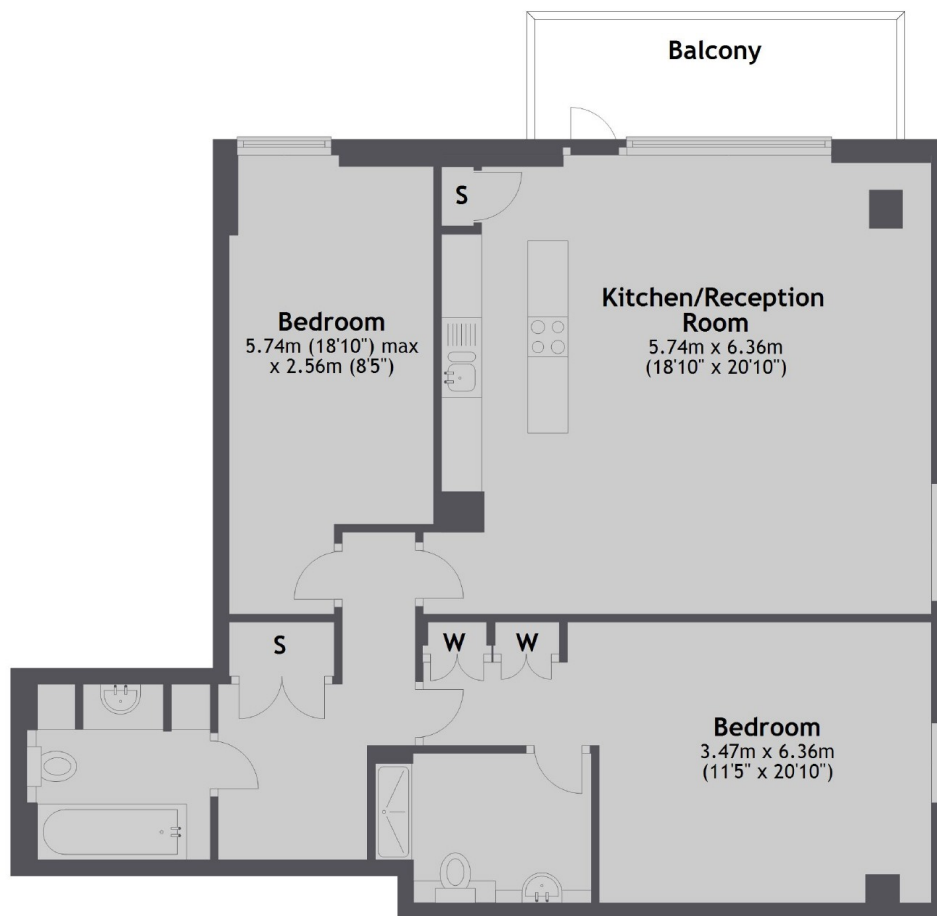

Total area: approx. 86.6 sq. metres (931.6 sq. feet)

Contact

To arrange a viewing call our office on the number below or visit our website.



Energy Rating: C. We aim to make our particulars both accurate and reliable. However they are not guaranteed; nor do they form part of an offer or contract. If you require clarification on any points then please contact us, especially if you're traveling some distance to view. Please note that appliances and heating systems have not been tested and therefore no warranties can be given as to their good working order.