



Lincoln Plaza, E14

£375,000

Offering water and Canary Wharf views, this one-bedroom home is located on the 20th floor of the sought-after Duckman Tower. The property benefits from wooden flooring, a private balcony, concierge service and is offered to the market with no onward chain.

Just a ten-minute walk from Canary Wharf, the property benefits from access to the Jubilee and Elizabeth lines, providing swift connections to the West End, Stratford's extensive shopping facilities and destinations across Greater London, including direct links to Heathrow Airport.

Features

- 20th Floor
- Dock and Canary Wharf Views
- Private Balcony
- Concierge Service
- Wooden Floors
- No Onward Chain

Lincoln Plaza, London, E14

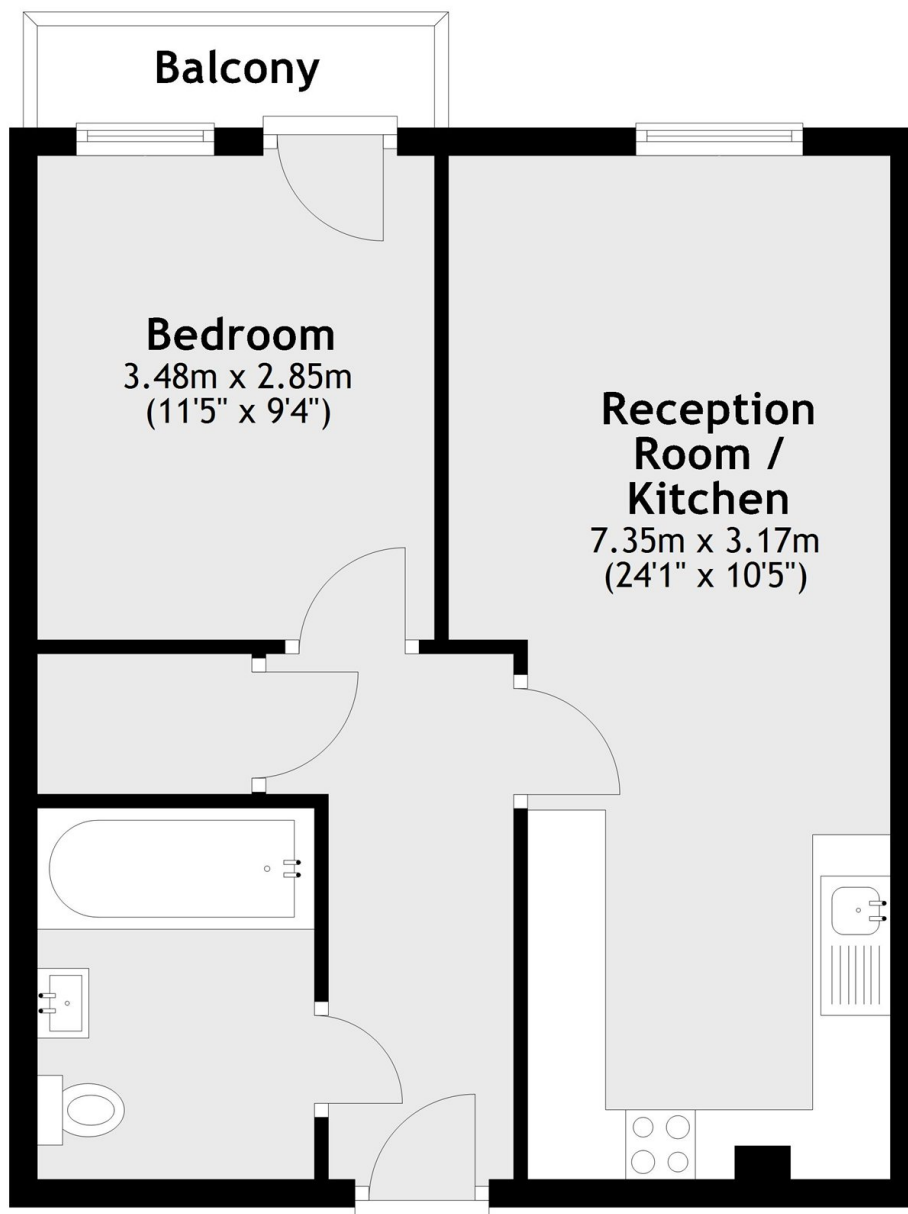

Main area: Approx. 45.0 sq. metres (484.6 sq. feet)

Plus balconies, approx. 2.4 sq. metres (25.5 sq. feet)