



Arnhem Place, E14

£600,000

Presented to the market is this two-bedroom home located within the sought-after riverside development, Arnhem Wharf. The property features a refitted kitchen and bathrooms, wooden flooring, secure allocated parking, concierge service, and a lease in excess of 900 years.

Arnhem Place is conveniently located approximately one mile from Canary Wharf station.

Features

- River Views
- Balcony Throughout
- Refitted Kitchen
- Refitted Bathrooms
- Secure Allocated
- 900 Plus Year Lease

Arnhem Place, London, E14

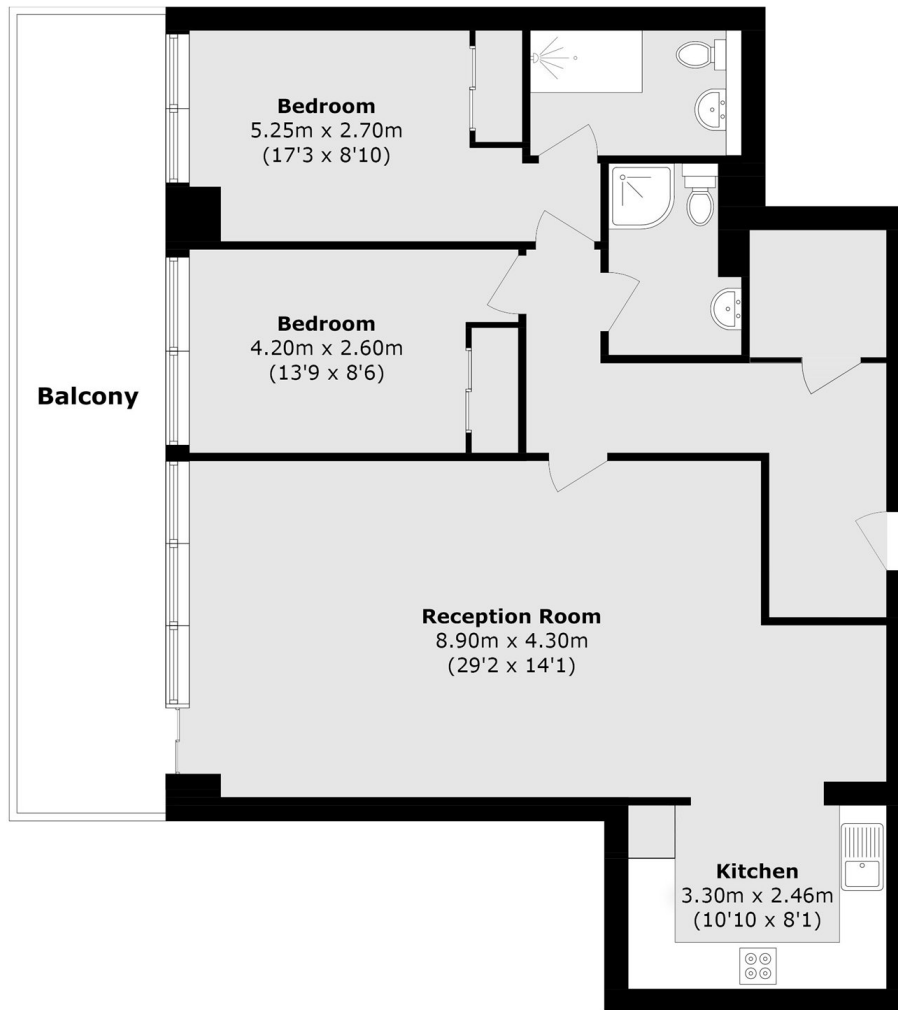

Second Floor

Total Area (approx.): 90.5 sq. m (974.1 sq. ft)

Balcony area (approx.): 18.8 sq. m (202.3 sq. ft)