



Lincoln Plaza, E14

£2,350 Per week

A bright one bedroom apartment on the sixteenth floor of this sought after development. This modern apartment has floor to ceiling windows, wooden flooring and two private balconies. The building comes with a 24 hour concierge, private winter garden and a roof terrace.

Duckman Tower is moments away from the bars and restaurants of South Quay, including the popular Lotus Floating Restaurant.

Features

- One Bedroom
- One Bathroom
- Concierge
- Wooden Flooring
- Balcony
- Ample Storage

Lincoln Plaza,
London, E14

Sixteenth Floor

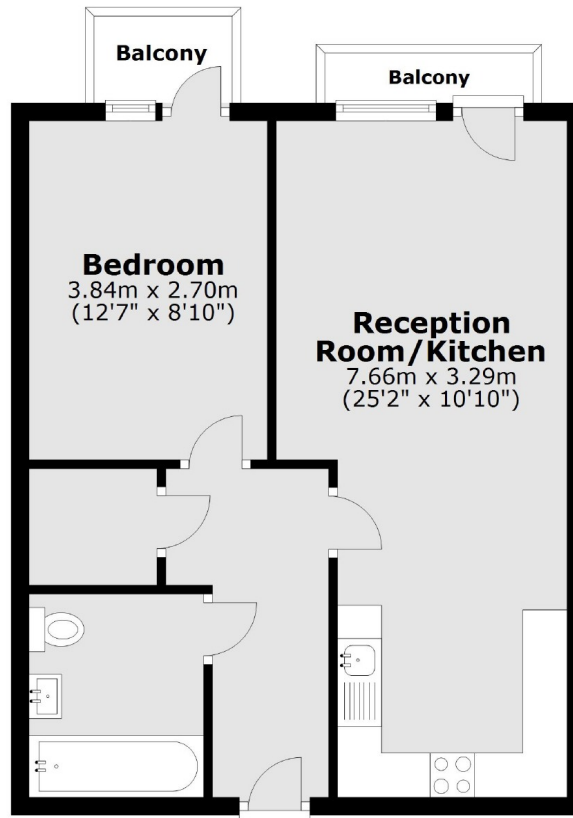

Main area: Approx. 46.6 sq. metres (502.1 sq. feet)
Plus balconies, approx. 1.6 sq. metres (16.8 sq. feet)