

## Westferry Road, E14

£450,000

Offered to the market chain-free and set within a sought-after riverside development, this property features an open-plan kitchen/reception area with access to a private balcony. Residents benefit from a wide range of facilities within the development, including concierge services, a gym, swimming pool, jacuzzi and sauna, tennis court, communal gardens, as well as a spacious barbecue area.

Cascades Tower is ideally situated within 0.5 miles of Canary Wharf station, offering multiple transport links including the DLR, Jubilee line and Elizabeth line. The property is also within a short walking distance of Thames Clipper services, providing swift connections to the City and beyond.

### Features

- 795 Square Feet
- Private Balcony
- 24 hour Concierge
- Resident Facilities
- 900+ Year Lease
- Parking Available

# Westferry Road, London, E14

## First Floor

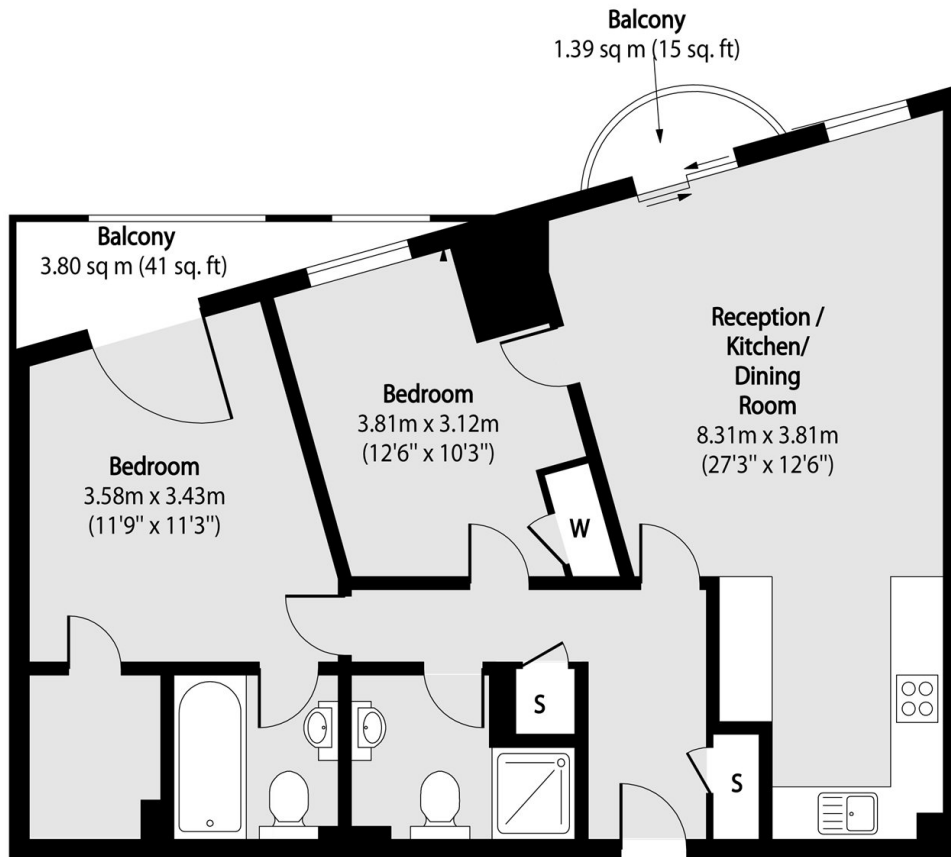

Total area (approx): 73.86 sq m (795 sq. ft)

Balcony total area (approx): 5.20 sq m (56 sq. ft)