



Devonshire Mews South, W1G

£1,100,000

A two bedroom, second floor apartment situated on a sought after mews in Marylebone. The property has two double bedrooms, a bathroom with separate WC and a west facing reception room.

Located between Devonshire Street and Weymouth Street, the property is within Marylebone Village and the medical district of the West End. Bond Street, Regent's Park, and Oxford Circus stations are all within half a mile.

Features

- Mid-Term Lease
- Cobbled Mews
- Two Double Bedrooms
- West Facing Reception
- Galley Kitchen
- Marylebone Village



Devonshire Mews South, London, W1G

This property is one of just a few apartments available on Devonshire Mews South. The generously sized galley kitchen has been fully refurbished to include Miele and Gaggenau appliances.

The west facing reception room provides plenty of natural light making this apartment ideal for entertaining, while the master double bedroom and second bedroom allow for flexible living space. There is a bathroom, with separate WC and deep storage cupboard just off the entrance hallway.

Devonshire Mews South is a pretty cobbled mews allowing for secure community style living in the heart of the West End, making this an ideal central London base or primary Marylebone Village residence.





Devonshire Mews South, London, W1G

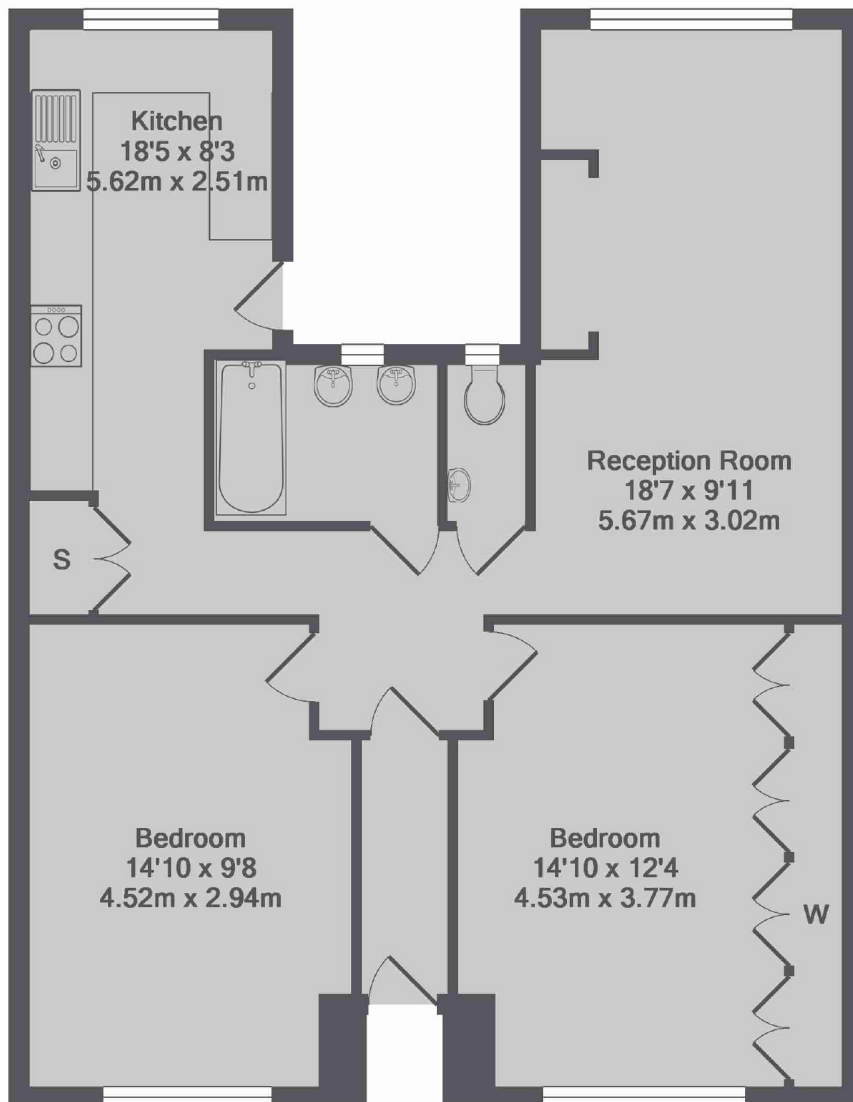

Devonshire Mews South, W1G
Total Approx. Floor Area 785 Sq.Ft. (72.9 Sq.M.)
Made with Metropix ©2016

Contact

To arrange a viewing call our office on the number below or visit our website.



Energy Rating: C. We aim to make our particulars both accurate and reliable. However they are not guaranteed; nor do they form part of an offer or contract. If you require clarification on any points then please contact us, especially if you're traveling some distance to view. Please note that appliances and heating systems have not been tested and therefore no warranties can be given as to their good working order.