



## Harrowby Street, W1H

£679,950

A two double bedroom, two bathroom apartment situated in a red brick residential block. Located moments from the boutiques, shops and restaurants of Portman and Connaught Villages and Hyde Park.

Conveniently located for the transport links of Marble Arch and London Marylebone. Hyde Park and Paddington Basin are easily accessible.

### Features

Two Bedrooms  
En Suite  
Uniformed Concierge  
Lift  
Lease 999 From 2002  
Chain Free

Harrowby Street,  
London, W1H

Ground Floor

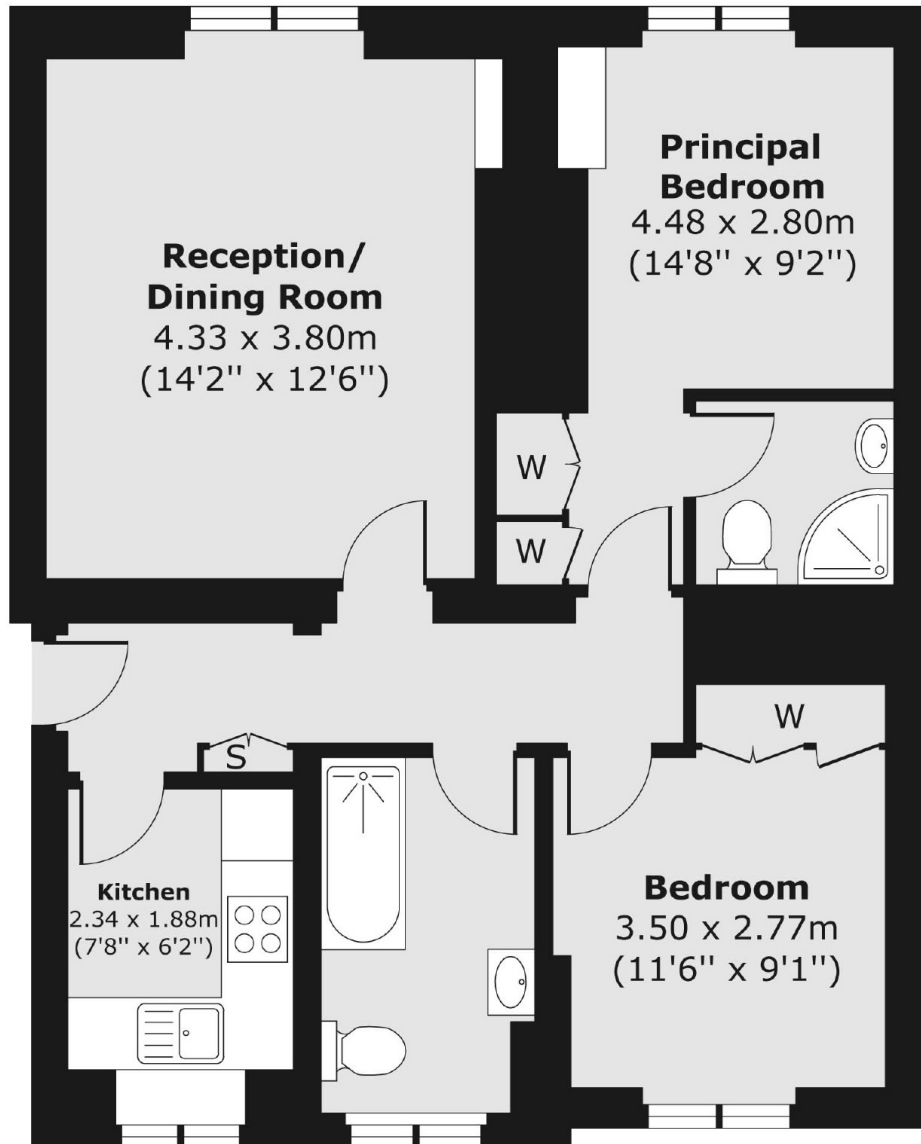

Total area (approx.) 60.46 sq. m (651 sq. ft)

**Dexters**

Marylebone  
53-55 Weymouth Street  
London  
W1G 8NJ  
Sales  
020 7224 5544

Energy Rating: D. We aim to make our particulars both accurate and reliable. However they are not guaranteed; nor do they form part of an offer or contract. If you require clarification on any points then please contact us, especially if you're traveling some distance to view. Please note that appliances and heating systems have not been tested and therefore no warranties can be given as to their good working order.

 **RICS** | Regulated  
Estate Agent  
and Letting Agent

[dexters.co.uk](https://www.dexters.co.uk)