

Chard

— ESTATE AGENTS —



Waldemar Avenue, SW6

£350,000

This is a wonderful opportunity to purchase a spacious one bedroom apartment in a sought after mansions block close to Parsons Green. This property comprises of a separate eat-in kitchen and living room, a double bedroom with ample storage and a bathroom. The property is filled with natural light and period features.

Waldemar Avenue is off Fulham Road where there are many bus routes leading into the city, Hammersmith and Putney. The closest underground station is Putney Bridge station. Bishops Park is moments away and there is a selection of cafés and restaurants close by

- One Bedroom • One Bathroom • Eat-in Kitchen •
 - Plenty Of Light • Mansion Block • Parsons Green Station •
-

Chard

— ESTATE AGENTS —

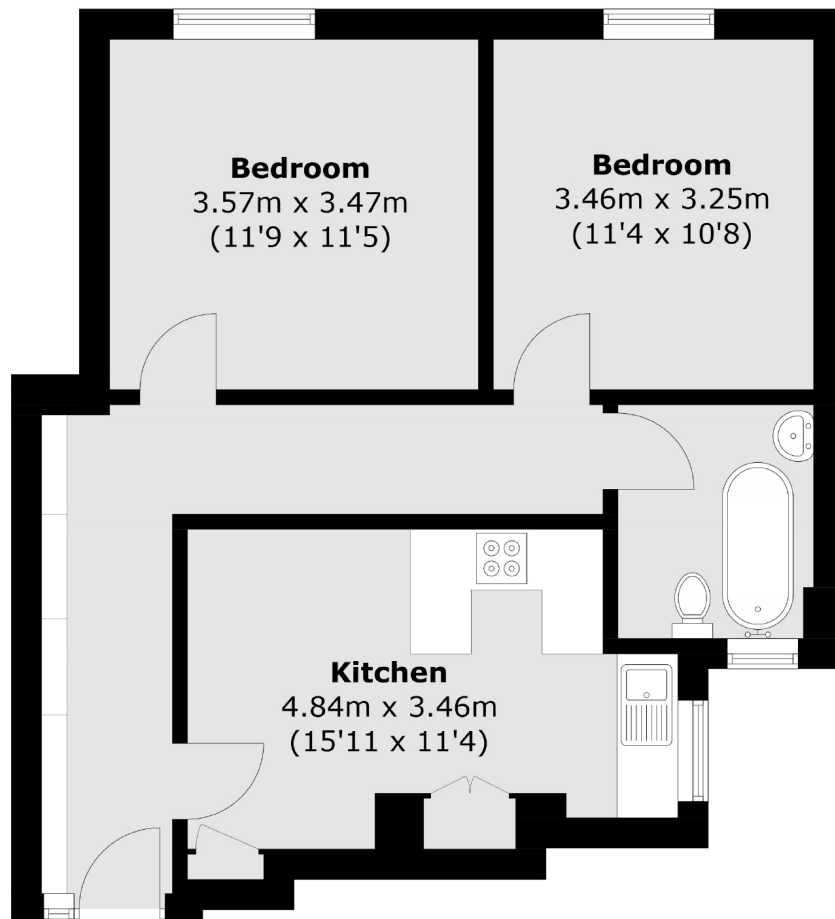

Total area (approx.): 56.2 sq. m (604.9 sq. ft)

Chard Fulham
656 Fulham Road,
London, SW6 5RX
020 7731 5115
fulhamsales@chard.co.uk

Energy Rating: . We aim to make our particulars both accurate and reliable. However they are not guaranteed; nor do they form part of an offer or contract. If you require clarification on any points then please contact us, especially if you're traveling some distance to view. Please note that appliances and heating systems have not been tested and therefore no warranties can be given as to their good working order.